

LEGEND

*SYMBOLS ARE PROVIDED FOR POSITIONAL REFERENCE ONLY, GCI SYSTEM DESIGN SHEETS SHOULD BE REFERRED TO FOR ACTUAL SYSTEM LAYOUT AND SPLICING.

FACILITY LINE TYPES & COLOR CODES

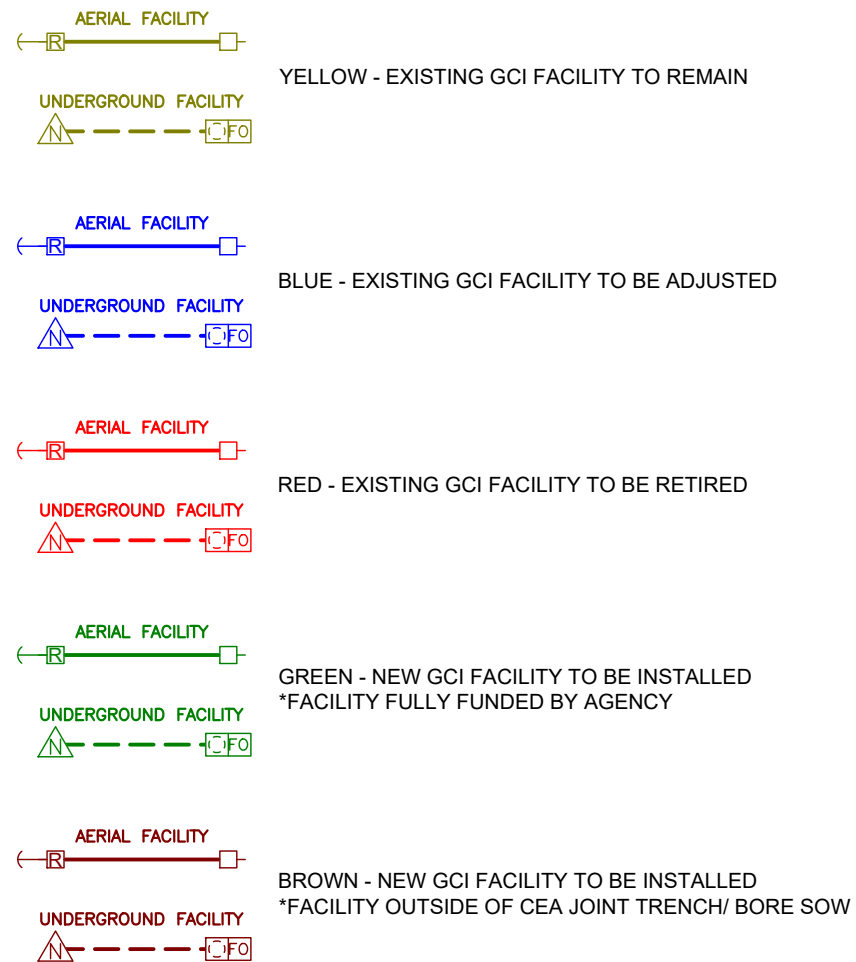

AERIAL FACILITY SYMBOLS

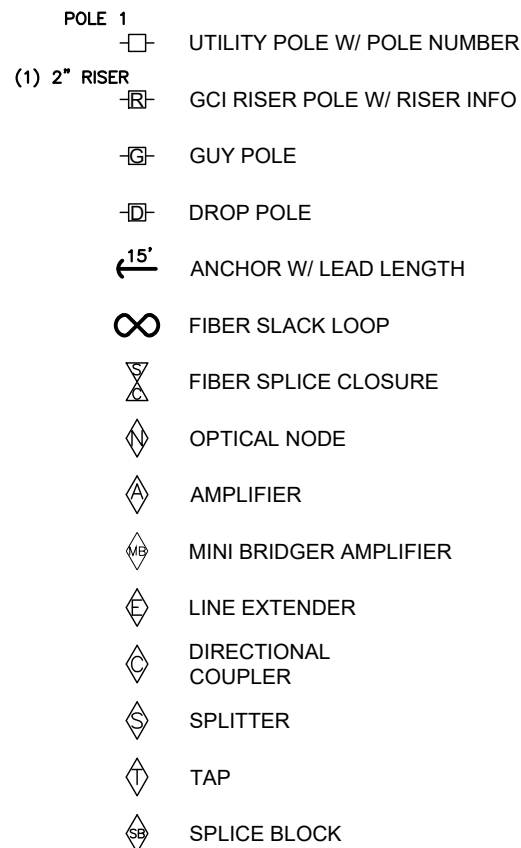

UNDERGROUND FACILITY SYMBOLS

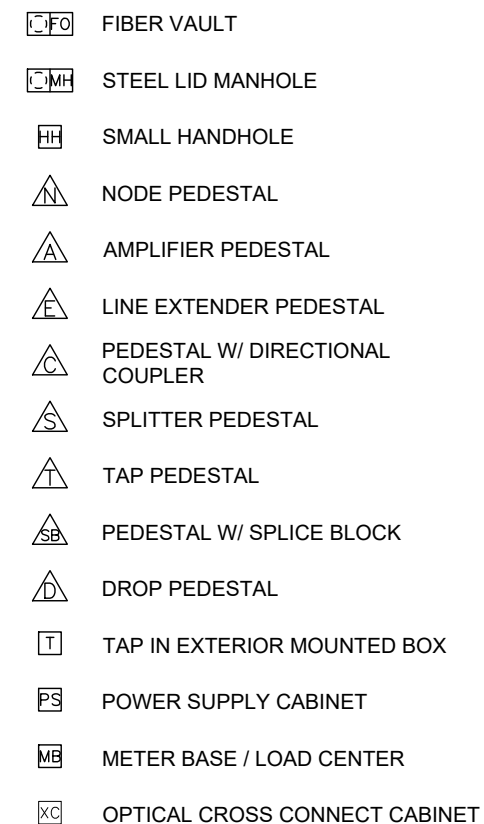

FACILITY ID CONVENTION

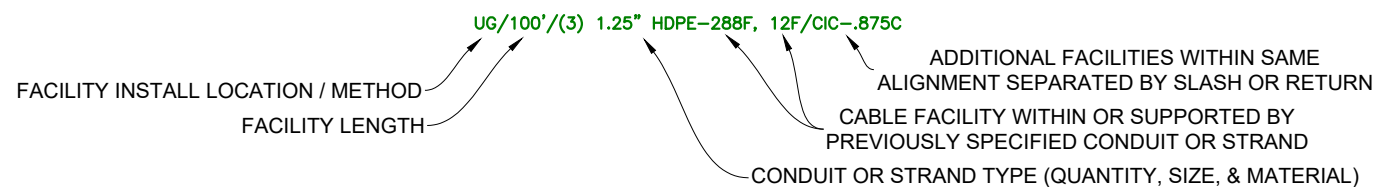

FACILITY ID SUFFIXES

C - COAXIAL CABLE
 F - FIBER OPTIC CABLE

COMMON ABBREVIATIONS

AC - ASPHALT CUT
 CIC - CABLE IN CONDUIT
 DBC - DIRECT BURIED CABLE
 DB - DIRECTIONAL BORE
 EHS - EXTRA HIGH STRENGTH (STRAND)
 HD - HAND DIG
 HB - HOG BORE
 JB - JOINT BORE
 JT - JOINT TRENCH
 OH - OVERHEAD
 PSF - POWER SUPPLY FEED
 STM - STATUS MONITORING
 SVC DRP - SERVICE DROP
 UG - UNDERGROUND

SPECIAL CONSTRUCTION METHODS

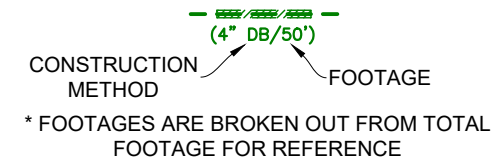

DRAWN BY: DESHANTE MCCASTER DATE: 5/16/2025
 PROJECT ENGINEER: ALEX SLAVENS ACCT: 113400.5

| NO. | DESIGN/CONSTRUCTION/ASBUILT REVISION | DWN BY/DATE |
|-----|--------------------------------------|-------------|
| 1 | | |
| 2 | | |
| 3 | | |
| 4 | | |
| 5 | | |
| 6 | | |
| 7 | | |



LEGEND

| | | | |
|---------------|-----------------------------------|--------------------|----------------------------------|
| YELLOW | EXISTING FACILITIES TO REMAIN | BROWN | NON-PARTICIPATING |
| RED | EXISTING FACILITIES TO BE RETIRED | PURPLE | TEMPORARY |
| GREEN | NEW FACILITIES | BLUE | EXISTING FACILITY TO BE ADJUSTED |
| ORANGE | BETTERMENTS | WHITE/BLACK | NOTES |

PROJECT NAME:
ER# 26469 / WO# 24-1623 / CEA# E2314213
AERO ACRES

GRIDS: NA SCALE:
 DRAWING NAME: 24-1623 Aero Acres_1 Line Design.dwg SHEET 1 OF 3

GCI LINE ITEM BID UNITS

NOTES:

Installation method of new GCI duct to be determined by the contractor. It is the contractor's responsibility to coordinate with GCI if the provided GCI materials are not suitable for the installation method choosen.

GCI will make GCI materials available for contractor pickup at GCI's Anchorage warehouse. Contractor shall provide GCI construction manager 30 days advanced notice of planned materials pick up date.

Pull string shall be installed in all GCI duct. All duct shall be stubbed above grade and left capped and sealed watertight. Contractor shall leave 3' of duct capped and sealed above grade at new GCI riser locations. GCI shall complete installation of new risers.

New GCI duct shall be installed with a minimum 1' of separation from other utility facility.

All splicing of GCI duct shall be made by means of a water and air tight mechanical connector.

GCI shall inspect and proof all conduit for acceptance prior to payment.

GCI shall complete all new cable installation, splicing, cut-over, service restoration, and retirement and wreck out of GCI facility. GCI shall not be responsible for retired CEA pole removal.

| In Contract GCI Bid Units | | |
|-----------------------------|------|----------|
| Item | Unit | Quantity |
| Install (1) 2" HDPE Duct | Feet | 874 |
| Install (1) 1.25" HDPE Duct | Feet | 2,868 |
| Install .625 CIC | Feet | 3,051 |
| Install Amplifier Pedestal | Each | 1 |
| Install LE Pedestal | Each | 5 |
| Install Tap Pedestal | Each | 13 |
| Instal Ground Rod | Each | 6 |

| Additional Not In Contract GCI Units | | |
|--------------------------------------|------|----------|
| Item | Unit | Quantity |
| Install (1) 1.25" HDPE Duct | Feet | 1,159 |
| Install Splitter Pedestal | Each | 1 |
| Install .875 CIC | Feet | 1159 |
| Pole Riser | Each | 1 |
| Anchor | Each | 1 |

DRAWN BY: DESHANTE MCCASTER DATE: 5/16/2025
 PROJECT ENGINEER: ALEX SLAVENS ACCT: 113400.5

| NO. | DESIGN/CONSTRUCTION/ASBUILT REVISION | DWN BY/DATE |
|-----|--------------------------------------|-------------|
| 1 | | |
| 2 | | |
| 3 | | |
| 4 | | |
| 5 | | |
| 6 | | |
| 7 | | |



| | | | |
|---------------|-----------------------------------|--------------------|----------------------------------|
| YELLOW | EXISTING FACILITIES TO REMAIN | BROWN | NON-PARTICIPATING |
| RED | EXISTING FACILITIES TO BE RETIRED | PURPLE | TEMPORARY |
| GREEN | NEW FACILITIES | BLUE | EXISTING FACILITY TO BE ADJUSTED |
| ORANGE | BETTERMENTS | WHITE/BLACK | NOTES |

PROJECT NAME:
ER# 26469 / WO# 24-1623 / CEA# E2314213
AERO ACRES

GRIDS: _____ SCALE: _____
 DRAWING NAME: 24-1623 Aero Acres_1 Line Design.dwg SHEET 2 OF 10

**VAULT INSTALLATION
DETAIL**

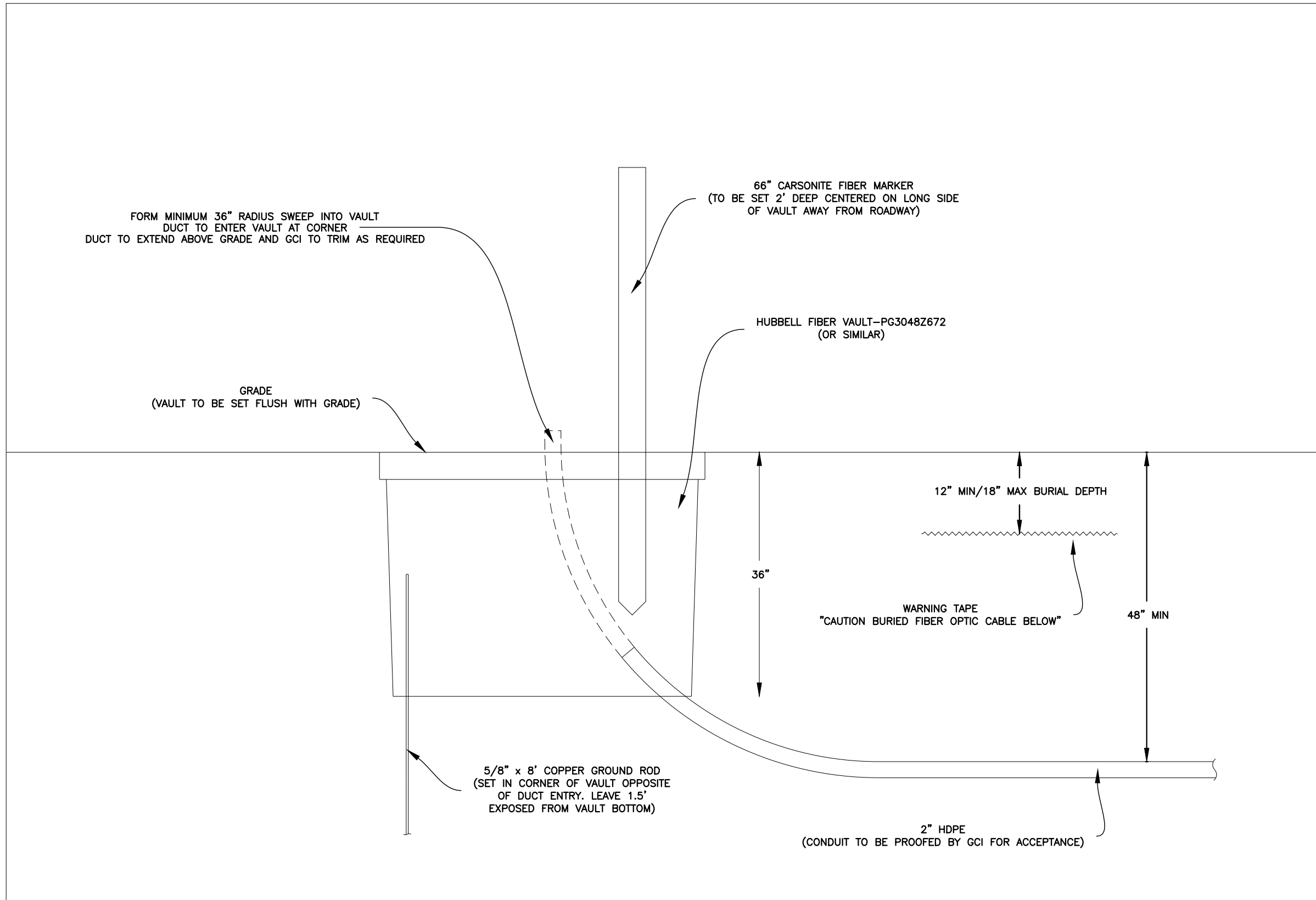

DRAWN BY: DESHANTE MCCASTER DATE: 5/16/2025
PROJECT ENGINEER: ALEX SLAVENS ACCT: 113400.5

| NO. | DESIGN/CONSTRUCTION/ASBUILT REVISION | DWN BY/DATE |
|-----|--------------------------------------|-------------|
| 1 | | |
| 2 | | |
| 3 | | |
| 4 | | |
| 5 | | |
| 6 | | |
| 7 | | |



| | | | |
|--|-----------------------------------|--|----------------------------------|
| YELLOW | EXISTING FACILITIES TO REMAIN | BROWN | NON-PARTICIPATING |
| RED | EXISTING FACILITIES TO BE RETIRED | PURPLE | TEMPORARY |
| GREEN | NEW FACILITIES | BLUE | EXISTING FACILITY TO BE ADJUSTED |
| ORANGE | BETTERMENTS | WHITE/BLACK | NOTES |

PROJECT NAME:
**ER# 26469 / WO# 24-1623 / CEA# E2314213
AERO ACRES**

GRIDS: _____ SCALE: _____
DRAWING NAME: 24-1623 Aero Acres_1 Line Design.dwg SHEET 3 OF 10

**PEDESTAL INSTALLATION
DETAIL**

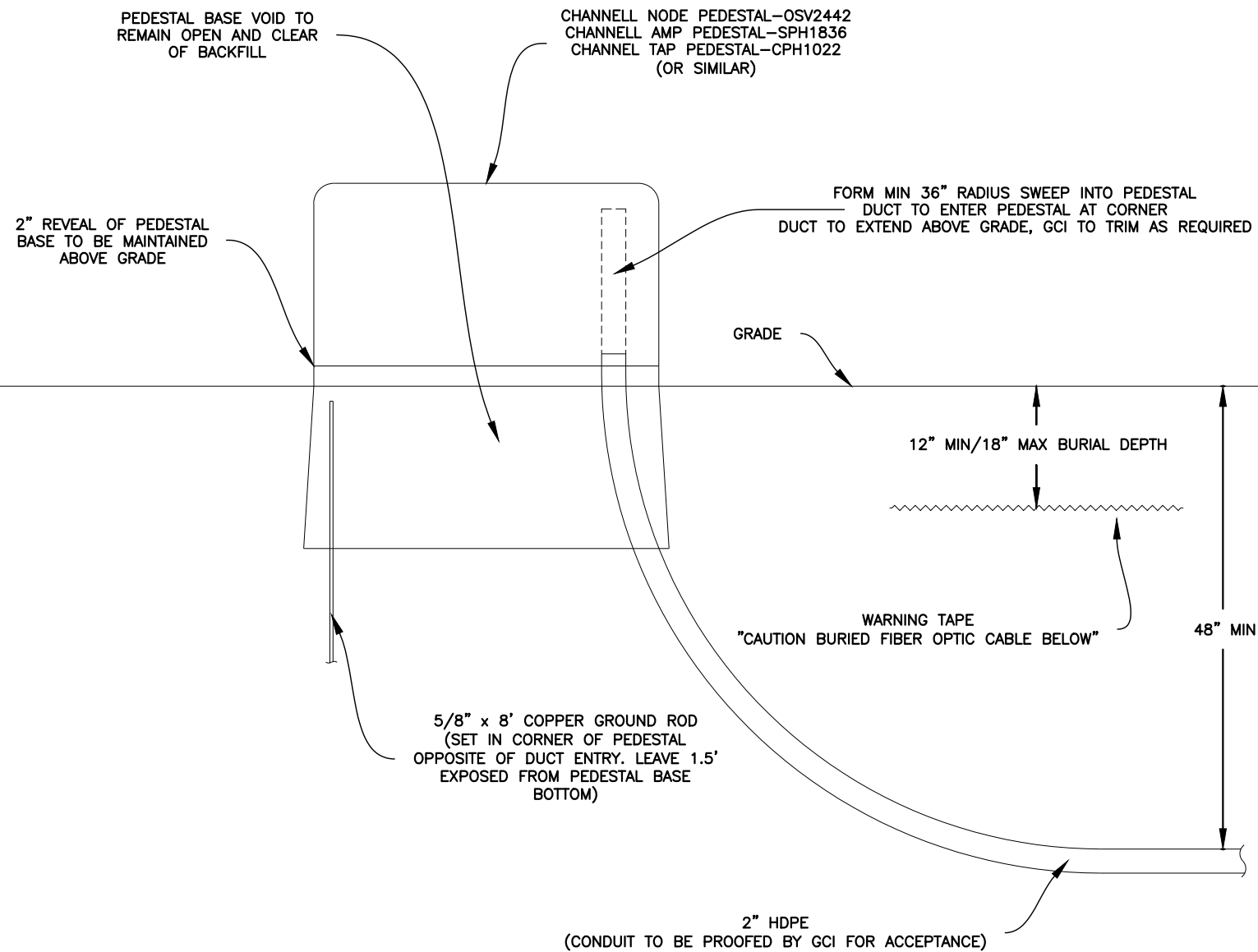

DRAWN BY: DESHANTE MCCASTER DATE: 5/16/2025
PROJECT ENGINEER: ALEX SLAVENS ACCT: 113400.5

| NO. | DESIGN/CONSTRUCTION/ASBUILT REVISION | DWN BY/DATE |
|-----|--------------------------------------|-------------|
| 1 | | |
| 2 | | |
| 3 | | |
| 4 | | |
| 5 | | |
| 6 | | |
| 7 | | |



| | | | |
|---------------|-----------------------------------|--------------------|----------------------------------|
| YELLOW | EXISTING FACILITIES TO REMAIN | BROWN | NON-PARTICIPATING |
| RED | EXISTING FACILITIES TO BE RETIRED | PURPLE | TEMPORARY |
| GREEN | NEW FACILITIES | BLUE | EXISTING FACILITY TO BE ADJUSTED |
| ORANGE | BETTERMENTS | WHITE/BLACK | NOTES |

PROJECT NAME:
**ER# 26469 / WO# 24-1623 / CEA# E2314213
AERO ACRES**

GRIDS: _____ SCALE: _____
DRAWING NAME: 24-1623 Aero Acres_1 Line Design.dwg SHEET 4 OF 10

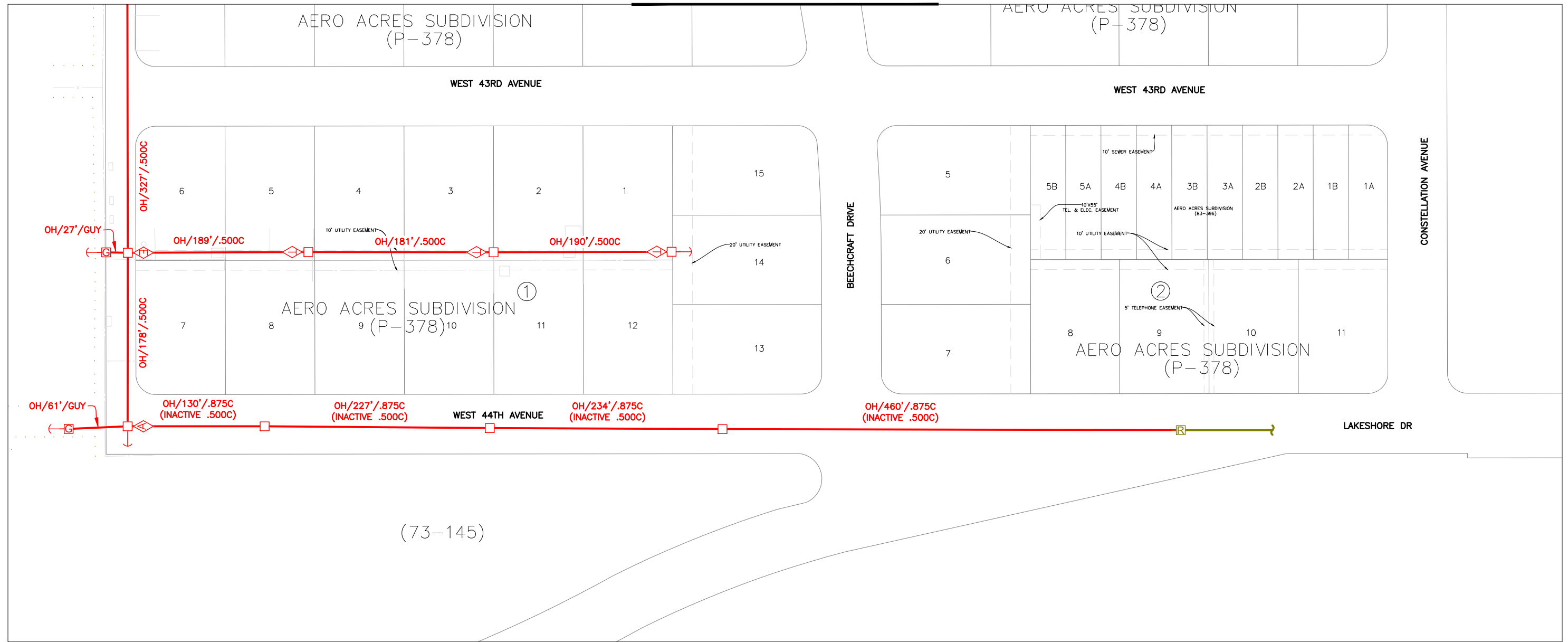

RETIREMENT

- 1.) Retire as designed.

DRAWN BY: DESHANTE MCCASTER DATE: 5/16/2025
 PROJECT ENGINEER: ALEX SLAVENS ACCT: 113400.5

| NO. | DESIGN/CONSTRUCTION/ASBUILT REVISION | DWN BY/DATE |
|-----|--------------------------------------|-------------|
| 1 | | |
| 2 | | |
| 3 | | |
| 4 | | |
| 5 | | |
| 6 | | |
| 7 | | |

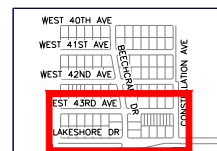

VICINITY MAP

| | | | |
|---------------|-----------------------------------|--------------------|----------------------------------|
| YELLOW | EXISTING FACILITIES TO REMAIN | BROWN | NON-PARTICIPATING |
| RED | EXISTING FACILITIES TO BE RETIRED | PURPLE | TEMPORARY |
| GREEN | NEW FACILITIES | BLUE | EXISTING FACILITY TO BE ADJUSTED |
| ORANGE | BETTERMENTS | WHITE/BLACK | NOTES |

PROJECT NAME:
ER# 26469 / WO# 24-1623 / CEA# E2314213
AERO ACRES



SHEET 5

RETIREMENT

- 1.) Retire as designed.

DRAWN BY: DESHANTE MCCASTER DATE: 5/16/2025
 PROJECT ENGINEER: ALEX SLAVENS ACCT: 113400.5

| NO. | DESIGN/CONSTRUCTION/ASBUILT REVISION | DWN BY/DATE |
|-----|--------------------------------------|-------------|
| 1 | | |
| 2 | | |
| 3 | | |
| 4 | | |
| 5 | | |
| 6 | | |
| 7 | | |

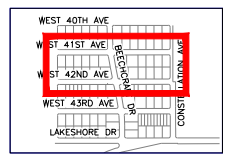

VICINITY MAP

| | | | |
|---------------|-----------------------------------|--------------------|----------------------------------|
| YELLOW | EXISTING FACILITIES TO REMAIN | BROWN | NON-PARTICIPATING |
| RED | EXISTING FACILITIES TO BE RETIRED | PURPLE | TEMPORARY |
| GREEN | NEW FACILITIES | BLUE | EXISTING FACILITY TO BE ADJUSTED |
| ORANGE | BETTERMENTS | WHITE/BLACK | NOTES |

PROJECT NAME:
ER# 26469 / WO# 24-1623 / CEA# E2314213
AERO ACRES

GRIDS: 1726, 1826 SCALE: 1:100
 DRAWING NAME: 24-1623 Aero Acres_1 Line Design.dwg
 SHEET 6 OF 10

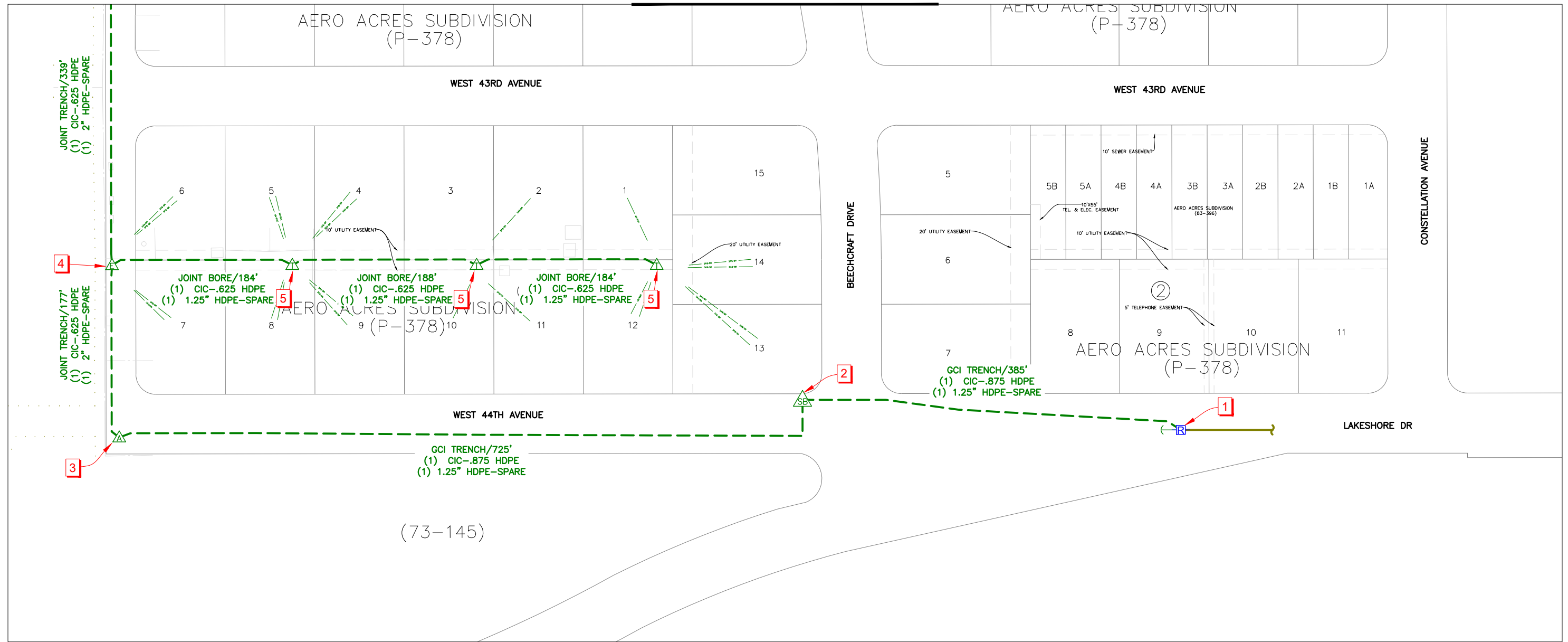

NEW FACILITY

GCI to coordinate with CEA contractor to place conduit for GCI facilities in the joint alignment. All underground shown is joint build, unless specified otherwise.

- 1.) Splice new .875C to the existing .875C at the top of the utility pole. Place an anchor.
- 2.) Place new pedestal.
- 3.) Place new AMP pedestal.
- 4.) Place LE pedestal.
- 5.) Place TAP pedestal.

DRAWN BY: DESHANTE MCCASTER DATE: 5/16/2025
 PROJECT ENGINEER: ALEX SLAVENS ACCT: 113400.5

| NO. | DESIGN/CONSTRUCTION/ASBUILT REVISION | DWN BY/DATE |
|-----|--------------------------------------|-------------|
| 1 | | |
| 2 | | |
| 3 | | |
| 4 | | |
| 5 | | |
| 6 | | |
| 7 | | |



VICINITY MAP

| | | | |
|---------------|-----------------------------------|--------------------|----------------------------------|
| YELLOW | EXISTING FACILITIES TO REMAIN | BROWN | NON-PARTICIPATING |
| RED | EXISTING FACILITIES TO BE RETIRED | PURPLE | TEMPORARY |
| GREEN | NEW FACILITIES | BLUE | EXISTING FACILITY TO BE ADJUSTED |
| ORANGE | BETTERMENTS | WHITE/BLACK | NOTES |

PROJECT NAME:
ER# 26469 / WO# 24-1623 / CEA# E2314213
AERO ACRES

GRIDS: 1726, 1826 SCALE: 1:100
 DRAWING NAME: 24-1623 Aero Acres_1 Line Design.dwg SHEET 7 OF 10

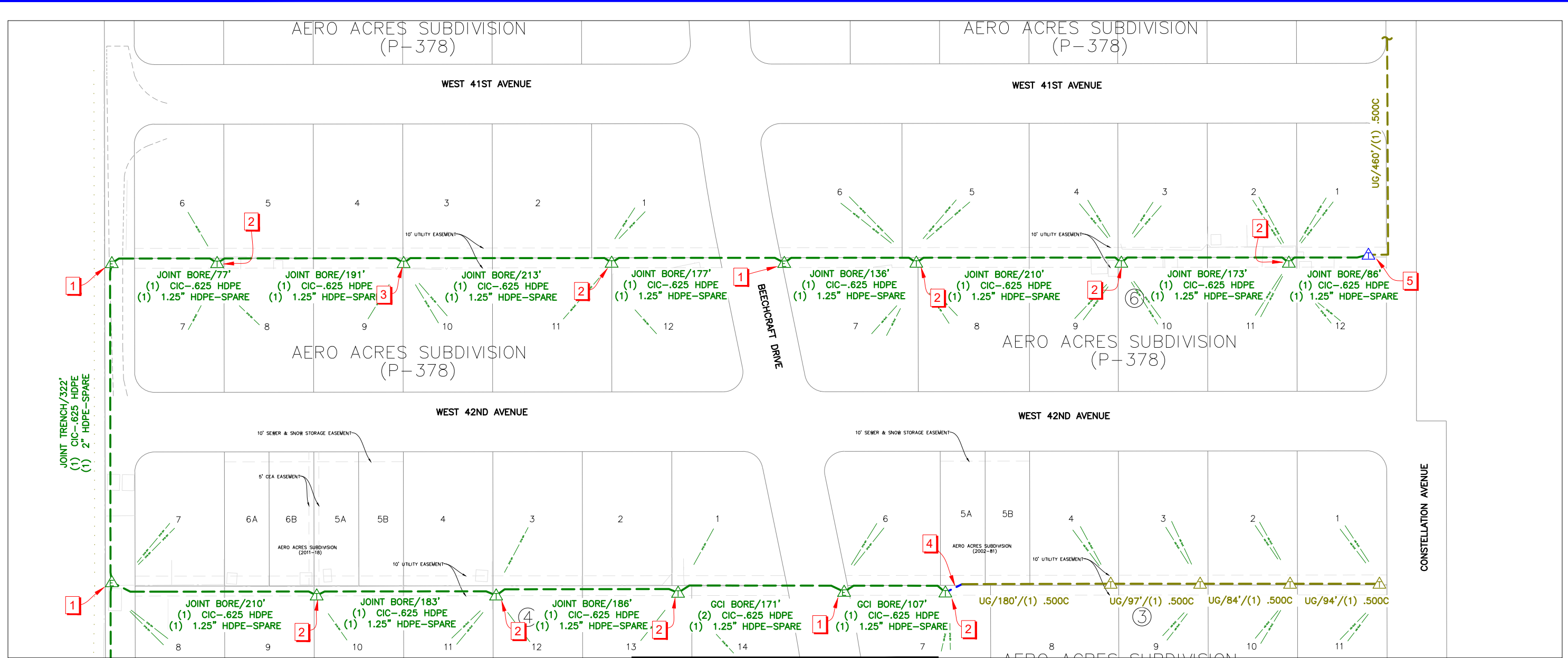

SHEET 7

NEW FACILITY

GCI to coordinate with CEA contractor to place conduit for GCI facilities in the joint alignment. All underground shown is joint build, unless specified otherwise.

- 1.) Place LE pedestal.
- 2.) Place TAP pedestal.
- 3.) Place Coupler pedestal.
- 4.) Adjust existing .500C to the new pedestal location. Splice as designed.
- 5.) Splice as designed inside existing pedestal.

DRAWN BY: DESHANTE MCCASTER DATE: 5/16/2025
 PROJECT ENGINEER: ALEX SLAVENS ACCT: 113400.5

| NO. | DESIGN/CONSTRUCTION/ASBUILT REVISION | DWN BY/DATE |
|-----|--------------------------------------|-------------|
| 1 | | |
| 2 | | |
| 3 | | |
| 4 | | |
| 5 | | |
| 6 | | |
| 7 | | |

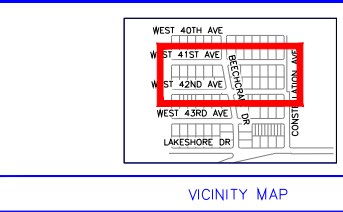
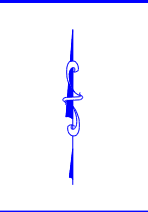

| | | | |
|---------------|-----------------------------------|--------------------|----------------------------------|
| YELLOW | EXISTING FACILITIES TO REMAIN | BROWN | NON-PARTICIPATING |
| RED | EXISTING FACILITIES TO BE RETIRED | PURPLE | TEMPORARY |
| GREEN | NEW FACILITIES | BLUE | EXISTING FACILITY TO BE ADJUSTED |
| ORANGE | BETTERMENTS | WHITE/BLACK | NOTES |

PROJECT NAME:
ER# 26469 / WO# 24-1623 / CEA# E2314213
AERO ACRES

GRIDS: 1726, 1826 SCALE: 1:100
 DRAWING NAME: 24-1623 Aero Acres_1 Line Design.dwg SHEET 8 OF 10

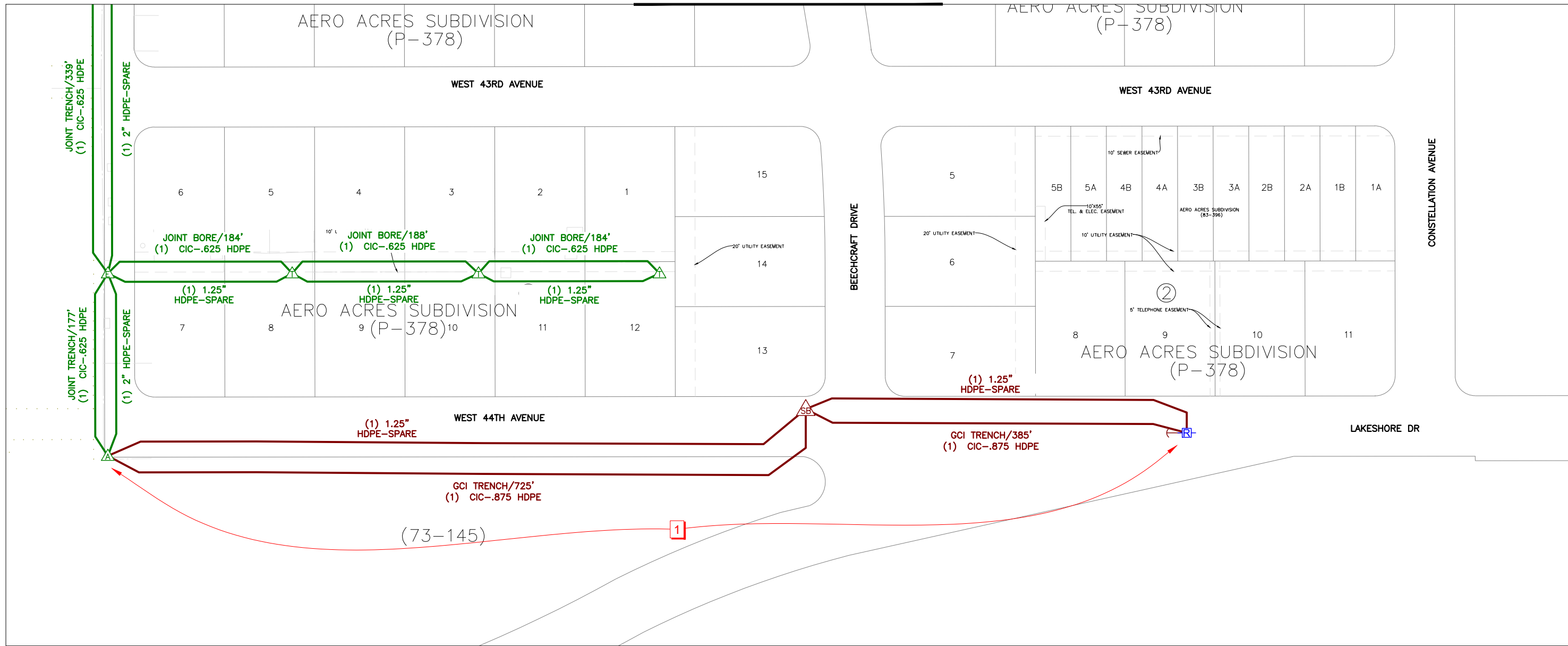

CONDUIT SCHEMATIC

See pages 7 for details.

1.) The underground construction from the Riser pole to the Amplifier pedestal is to be negotiated between GCI and the primary contractor. It is not included inside of CEAs' T21 construction.

| | | | |
|-------------------|-----------------------------|----------|-------------|
| DRAWN BY: | DESHANTE MCCASTER | DATE: | 5/16/2025 |
| PROJECT ENGINEER: | ALEX SLAVENS | ACCT: | 113400.5 |
| NO. | DESIGN/CONSTRUCTION/ASBUILT | REVISION | DWN BY/DATE |
| 1 | | | |
| 2 | | | |
| 3 | | | |
| 4 | | | |
| 5 | | | |
| 6 | | | |
| 7 | | | |

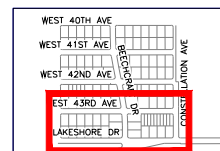

VICINITY MAP

| | | | |
|---------------|-----------------------------------|--------------------|----------------------------------|
| YELLOW | EXISTING FACILITIES TO REMAIN | BROWN | NON-PARTICIPATING |
| RED | EXISTING FACILITIES TO BE RETIRED | PURPLE | TEMPORARY |
| GREEN | NEW FACILITIES | BLUE | EXISTING FACILITY TO BE ADJUSTED |
| ORANGE | BETTERMENTS | WHITE/BLACK | NOTES |

| | |
|-------------------|--|
| PROJECT NAME: | ER# 26469 / WO# 24-1623 / CEA# E2314213 AERO ACRES |
| GRIDS: 1726, 1826 | SCALE: 1:100 |
| DRAWING NAME: | 24-1623 Aero Acres_1 Line Design.dwg |
| SHEET | 9 OF 10 |



SHEET 9

CONDUIT SCHEMATIC

See pages 8 for details.

1.) The underground construction from the Riser pole to the Amplifier pedestal is to be negotiated between GCI and the primary contractor. It is not included inside of CEAs' T21 construction.

| | |
|---|--------------------------------------|
| DRAWN BY: <u>DESHANTE MCCASTER</u> DATE: <u>5/16/2025</u> | |
| PROJECT ENGINEER: <u>ALEX SLAVENS</u> ACCT: <u>113400.5</u> | |
| NO. | DESIGN/CONSTRUCTION/ASBUILT REVISION |
| 1 | |
| 2 | |
| 3 | |
| 4 | |
| 5 | |
| 6 | |
| 7 | |

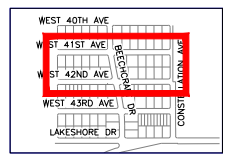

VICINITY MAP

| | | | |
|---------------|-----------------------------------|--------------------|----------------------------------|
| YELLOW | EXISTING FACILITIES TO REMAIN | BROWN | NON-PARTICIPATING |
| RED | EXISTING FACILITIES TO BE RETIRED | PURPLE | TEMPORARY |
| GREEN | NEW FACILITIES | BLUE | EXISTING FACILITY TO BE ADJUSTED |
| ORANGE | BETTERMENTS | WHITE/BLACK | NOTES |

| | |
|-------------------|--|
| PROJECT NAME: | ER# 26469 / WO# 24-1623 / CEA# E2314213 AERO ACRES |
| GRIDS: 1726, 1826 | SCALE: 1:100 |
| DRAWING NAME: | 24-1623 Aero Acres_1 Line Design.dwg |
| | SHEET 10 OF 10 |