

VICINITY KEY MAP
N.T.S.

LEGEND		DESC.
NEW	EXISTING	
		VAULT
		JUNCTION BOX
		SWITCH CABINET
		PULLBOX
		PADMOUNT XFMR
		FUSED JUNCTION BOX
		PRIMARY METER
		HANDHOLE
		PEDESTAL
		NON-CEA POLE
		POLE
		LIGHT
		DOWN GUY
		FUSE
		SPLICE POINT
		1Ø OH XFMR
		DELTA OH XFMR
		3Ø OH XFMR
		FIBER OPTIC
		O.H. XMSSN
		U.G. XMSSN
		SPAN GUY
		CONDUIT DIAMETER
		1Ø U.G. PRIMARY
		2Ø U.G. PRIMARY
		3Ø U.G. PRIMARY
		U.G. SECONDARY
		U.G. SERVICE
		1Ø O.H. PRIMARY
		2Ø O.H. PRIMARY
		3Ø O.H. PRIMARY
		R.O.W. EASEMENT LINE
		CENTERLINE OF TRENCH

COLOR LEGEND

	NEW
	REFERENCE
	EXISTING
	RETIRE
	ABANDON

UNLESS OTHERWISE NOTED CHUGACH FACILITIES WILL BE INSTALLED AS SHOWN BELOW

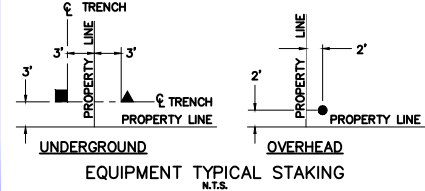

PROJECT: RBSS 312 PD TESTING & REPAIR - SI		W.O. #: E2214138	
DESIGNER/PROJECT ENGINEER: E. COOK			
NO.	DESIGN/CONSTRUCTION/AS-BUILT REVISION	DWN BY/DATE	APPROVED/DATE
0	ISSUE FOR CONSTRUCTION	EC 2/24/26	3/20/26

ENG. STAMP



Chugach Electric Association, Inc.
5601 Electron Drive - P.O. Box 196300
Anchorage, Alaska 99519-6300

DRAWING NAME:	RBSS 312 PD TESTING & REPAIR SYSTEM IMPROVEMENT
	1820, 1821, 1822, 1920, 2019, 2024 / 1304-32, 1304-33, 1204-03, 1204-06
	RBSS 312 VICINITY MAP
W.O. NO.:	E2214138
	E2214138 DRAWNGS.dwg
	PAGE 0 OF 12

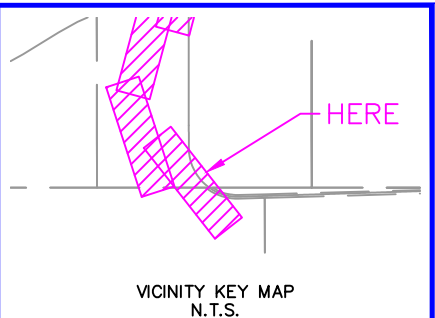
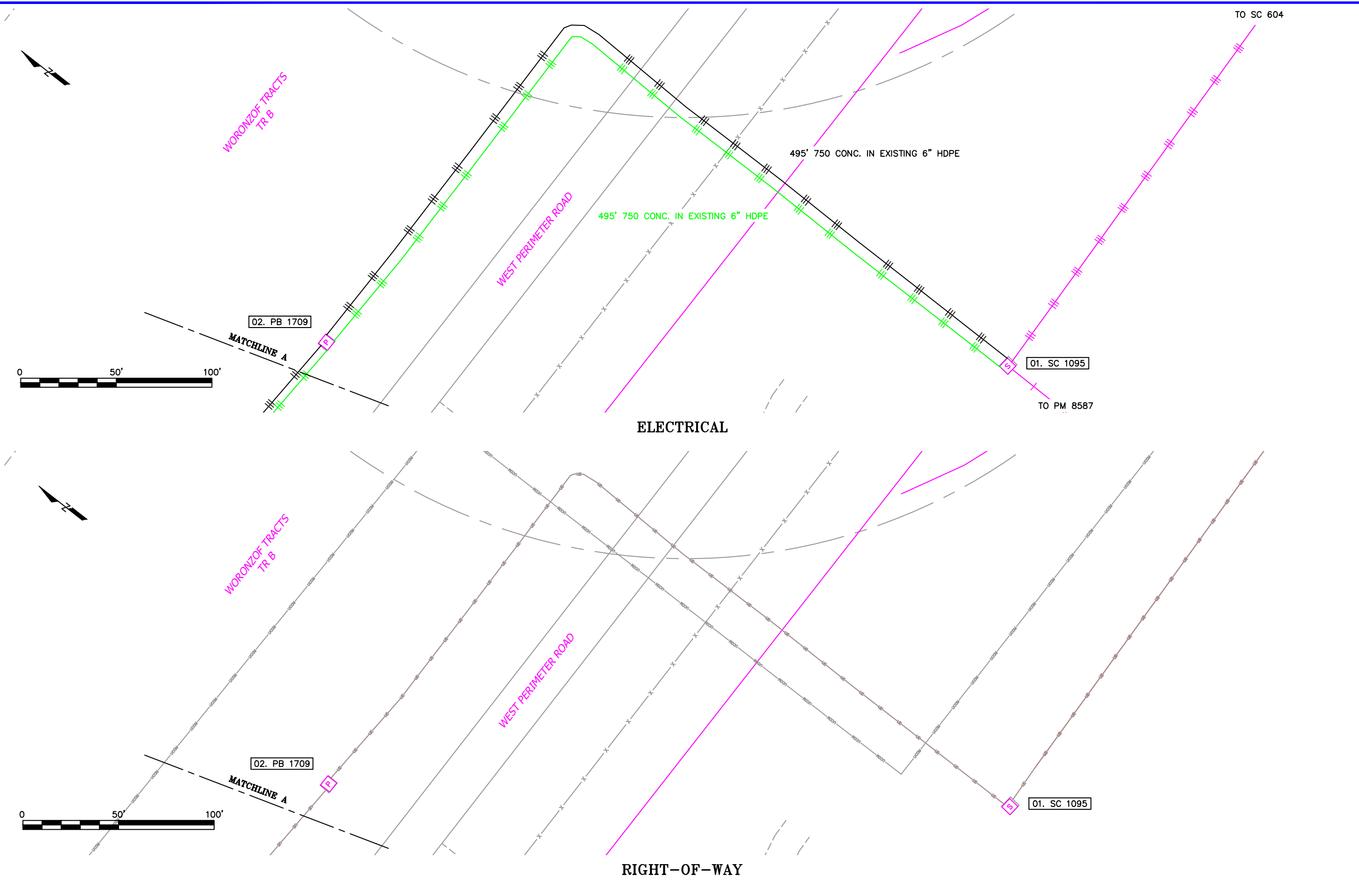

NEW	EXISTING	DESC.
		VAULT
		JUNCTION BOX
		SWITCH CABINET
		PULLBOX
		PADMOUNT XFMR
		FUSED JUNCTION BOX
		PRIMARY METER
		HANDHOLE
		PEDESTAL
		NON-CEA POLE
		POLE
		LIGHT
		DOWN GUY
		FUSE
		SPLICE POINT
		1Ø OH XFMR
		DELTA OH XFMR
		3Ø OH XFMR
		FIBER OPTIC
		O.H. XMSSN
		U.G. XMSSN
		SPAN GUY
		CONDUIT DIAMETER
		1Ø U.G. PRIMARY
		2Ø U.G. PRIMARY
		3Ø U.G. PRIMARY
		U.G. SECONDARY
		U.G. SERVICE
		1Ø O.H. PRIMARY
		2Ø O.H. PRIMARY
		3Ø O.H. PRIMARY
		R.O.W. EASEMENT LINE
		CENTERLINE OF TRENCH

COLOR LEGEND	
	NEW
	REFERENCE
	EXISTING
	RETIRE
	ABANDON

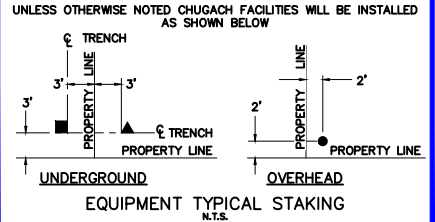

PROJECT: RBSS 312 PD TESTING & REPAIR - SI			
DESIGNER/PROJECT ENGINEER: E. COOK		W.O. #: E2214138	
NO.	DESIGN/CONSTRUCTION/AS-BUILT REVISION	DWN BY/DATE	APPROVED/DATE
0	ISSUE FOR CONSTRUCTION	EC 2/24/26	Jm 3/20/26

ENG. STAMP

Chugach Electric Association, Inc.
5601 Electron Drive - P.O. Box 196300
Anchorage, Alaska 99519-6300

DRAWING NAME: **RBSS 312 PD TESTING & REPAIR SYSTEM IMPROVEMENT**
1820, 1821, 1822, 1920, 2019, 2024 / 1304-32, 1304-33, 1204-03, 1204-06
RBSS 312

W.O. NO.: **E2214138**

E2214138 DRAWINGS.dwg
PAGE 1 OF 12

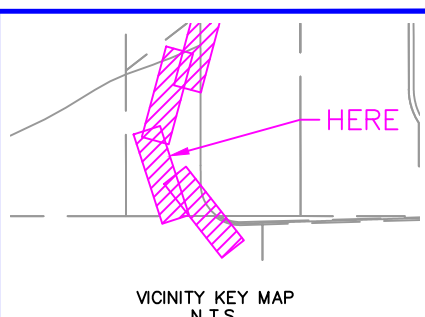
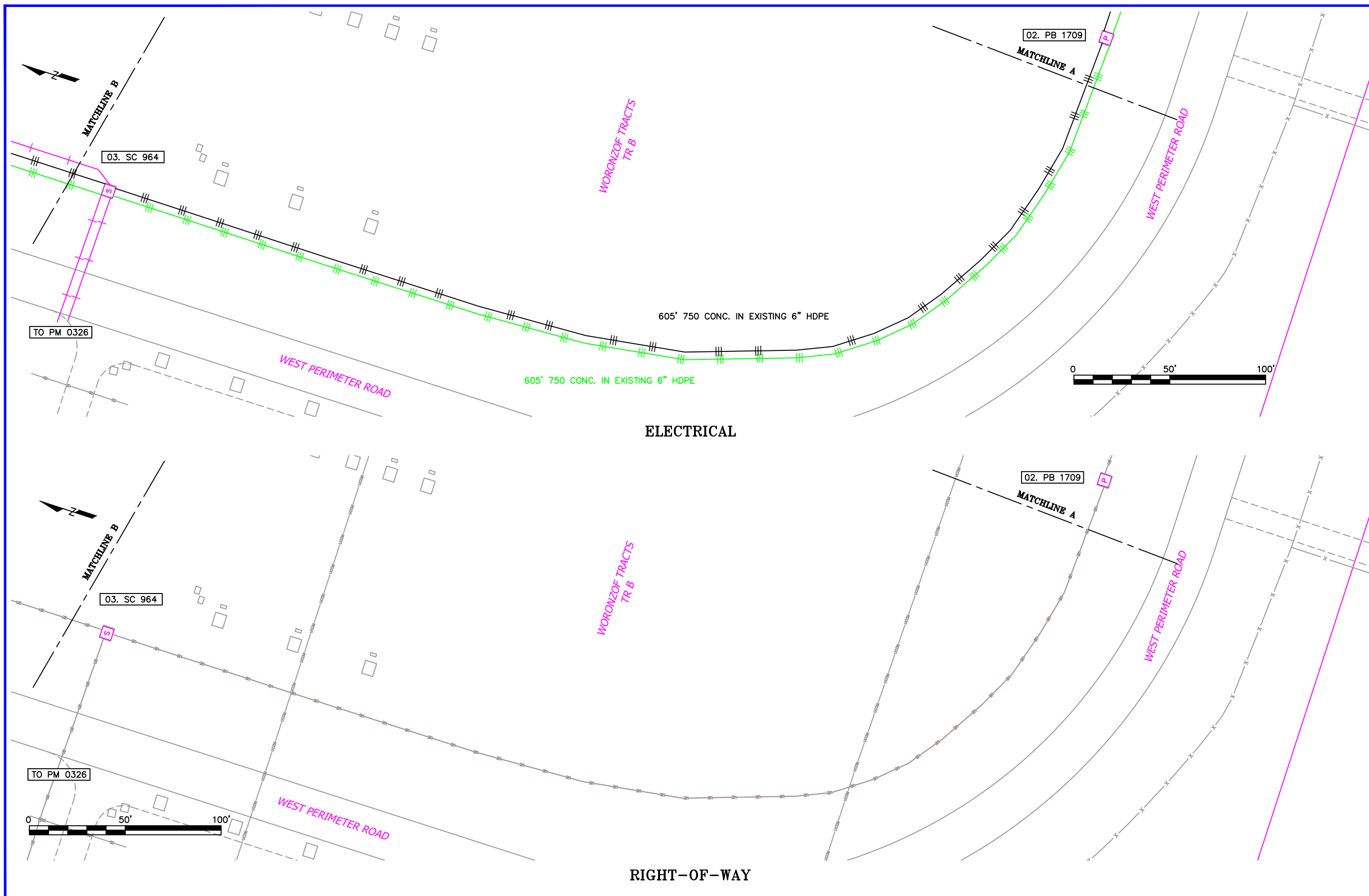

NEW	EXISTING	DESC.
		VAULT
		JUNCTION BOX
		SWITCH CABINET
		PULLBOX
		PADMOUNT XFMR
		FUSED JUNCTION BOX
		PRIMARY METER
		HANDHOLE
		PEDESTAL
		NON-CEA POLE
		POLE
		LIGHT
		DOWN GUY
		FUSE
		SPLICE POINT
		1Ø OH XFMR
		DELTA OH XFMR
		3Ø OH XFMR
		FIBER OPTIC
		O.H. XMSSN
		U.G. XMSSN
		SPAN GUY
		CONDUIT DIAMETER
		1Ø U.G. PRIMARY
		2Ø U.G. PRIMARY
		3Ø U.G. PRIMARY
		U.G. SECONDARY
		U.G. SERVICE
		1Ø O.H. PRIMARY
		2Ø O.H. PRIMARY
		3Ø O.H. PRIMARY
		R.O.W. EASEMENT LINE
		CENTERLINE OF TRENCH

COLOR LEGEND	
	NEW
	REFERENCE
	EXISTING
	RETIRE
	ABANDON

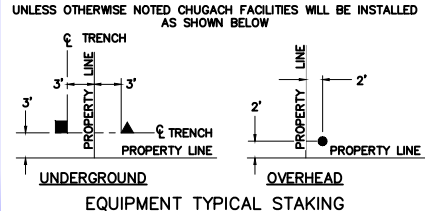

PROJECT: RBSS 312 PD TESTING & REPAIR - SI			
DESIGNER/PROJECT ENGINEER: E. COOK		W.O. #: E2214138	
NO.	DESIGN/CONSTRUCTION/AS-BUILT REVISION	DWN BY/DATE	APPROVED/DATE
0	ISSUE FOR CONSTRUCTION	EC 2/24/26	Jm 3/20/26

ENG. STAMP

Chugach Electric Association, Inc.
5601 Electron Drive - P.O. Box 196300
Anchorage, Alaska 99519-6300

DRAWING NAME: **RBSS 312 PD TESTING & REPAIR SYSTEM IMPROVEMENT**
1820, 1821, 1822, 1920, 2019, 2024 / 1304-32, 1304-33, 1204-03, 1204-06
RBSS 312

W.O. NO.: **E2214138**

E2214138 DRAWNGS.dwg
PAGE 2 OF 12

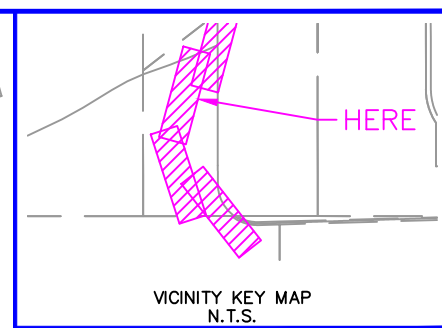
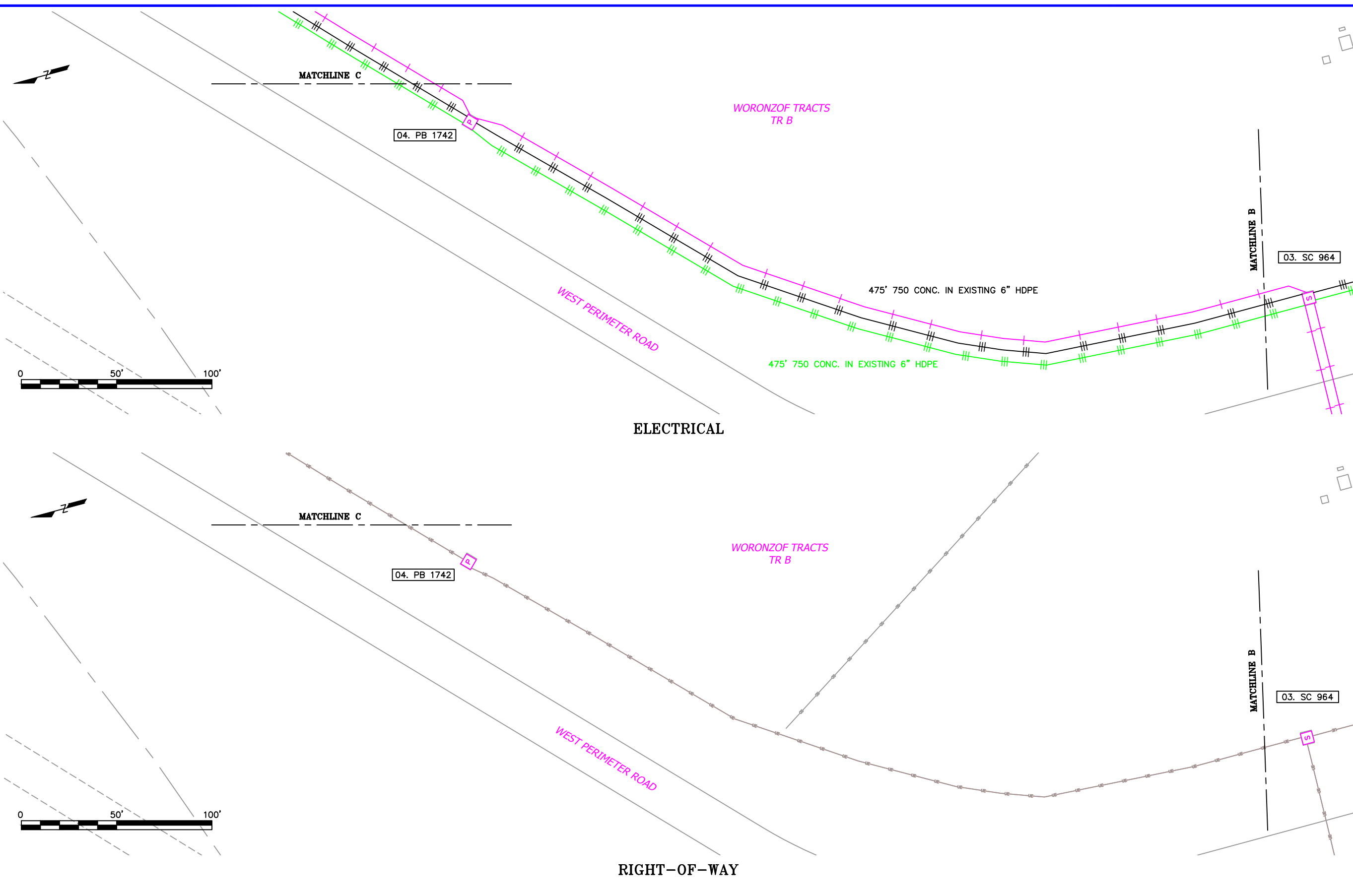

NEW	EXISTING	DESC.
		VAULT
		JUNCTION BOX
		SWITCH CABINET
		PULLBOX
		PADMOUNT XFMR
		FUSED JUNCTION BOX
		PRIMARY METER
		HANDHOLE
		PEDESTAL
		NON-CEA POLE
		POLE
		LIGHT
		DOWN GUY
		FUSE
		SPLICE POINT
		1Ø OH XFMR
		DELTA OH XFMR
		3Ø OH XFMR
		FIBER OPTIC
		O.H. XMSSN
		U.G. XMSSN
		SPAN GUY
		CONDUIT DIAMETER
		1Ø U.G. PRIMARY
		2Ø U.G. PRIMARY
		3Ø U.G. PRIMARY
		U.G. SECONDARY
		U.G. SERVICE
		1Ø O.H. PRIMARY
		2Ø O.H. PRIMARY
		3Ø O.H. PRIMARY
		R.O.W. EASEMENT LINE
		CENTERLINE OF TRENCH

COLOR LEGEND	
	NEW
	REFERENCE
	EXISTING
	RETIRE
	ABANDON

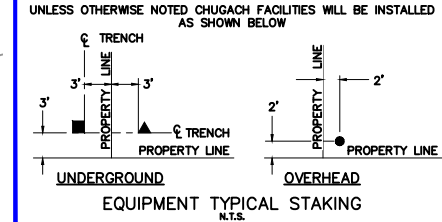

PROJECT: RBSS 312 PD TESTING & REPAIR - SI			
DESIGNER/PROJECT ENGINEER: E. COOK		W.O. #: E2214138	
NO.	DESIGN/CONSTRUCTION/AS-BUILT REVISION	DWN BY/DATE	APPROVED/DATE
0	ISSUE FOR CONSTRUCTION	EC 2/24/26	<i>Jm</i> 3/20/26

ENG. STAMP

Chugach Electric Association, Inc.
5601 Electron Drive - P.O. Box 196300
Anchorage, Alaska 99519-6300

DRAWING NAME:	RBSS 312 PD TESTING & REPAIR SYSTEM IMPROVEMENT
	1820, 1821, 1822, 1920, 2019, 2024 / 1304-32, 1304-33, 1204-03, 1204-06 RBSS 312
W.O. NO.:	E2214138
	E2214138 DRAWINGS.dwg
	PAGE 3 OF 12

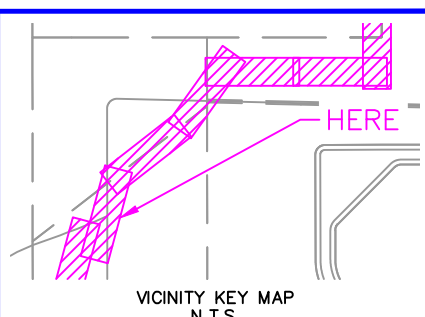
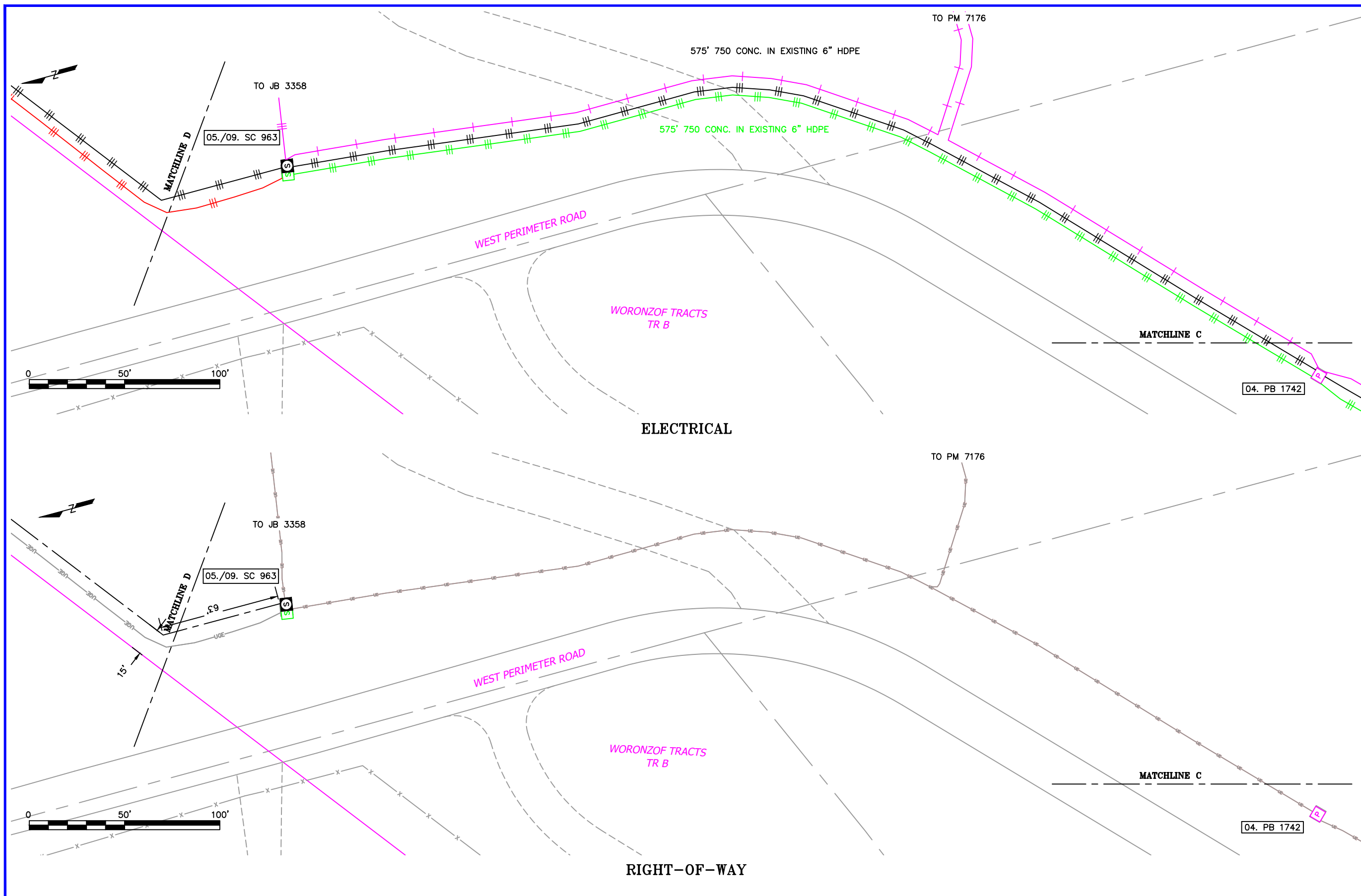

NEW	EXISTING	DESC.
[V]	[V]	VAULT
[J]	[J]	JUNCTION BOX
[S]	[S]	SWITCH CABINET
[P]	[P]	PULLBOX
[F]	[F]	PADMOUNT XFMR
[M]	[M]	FUSED JUNCTION BOX
[▲]	[▲]	PRIMARY METER
[▲]	[▲]	HANDHOLE
[●]	[●]	PEDESTAL
[⊗]	[⊗]	NON-CEA POLE
[●]	[○]	POLE
[*]	[*]	LIGHT
[↓]	[↓]	DOWN GUY
[~]	[~]	FUSE
[◇]	[◇]	SPLICE POINT
[⊥]	[⊥]	1Ø OH XFMR
[⊥⊥]	[⊥⊥]	DELTA OH XFMR
[⊥⊥⊥]	[⊥⊥⊥]	3Ø OH XFMR
[FO]	[FO]	FIBER OPTIC
[//]	[//]	O.H. XMSSN
[//]	[//]	U.G. XMSSN
[X]	[X]	SPAN GUY
[2"]	[2"]	CONDUIT DIAMETER
[+]	[+]	1Ø U.G. PRIMARY
[=]	[=]	2Ø U.G. PRIMARY
[≡]	[≡]	3Ø U.G. PRIMARY
[---]	[---]	U.G. SECONDARY
[---]	[---]	U.G. SERVICE
[---]	[---]	1Ø O.H. PRIMARY
[---]	[---]	2Ø O.H. PRIMARY
[---]	[---]	3Ø O.H. PRIMARY
[---]	[---]	R.O.W. EASEMENT LINE
[---]	[---]	CENTERLINE OF TRENCH

COLOR LEGEND	
[Solid Black]	NEW
[Dashed Black]	REFERENCE
[Solid Pink]	EXISTING
[Solid Green]	RETIRE
[Solid Red]	ABANDON

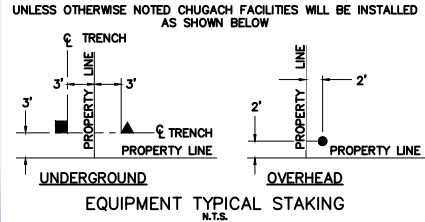

PROJECT: RBSS 312 PD TESTING & REPAIR - SI		W.O. #: E2214138	
DESIGNER/PROJECT ENGINEER: E. COOK			
NO.	DESIGN/CONSTRUCTION/AS-BUILT REVISION	DWN BY/DATE	APPROVED/DATE
0	ISSUE FOR CONSTRUCTION	EC 2/24/26	[Signature] 3/20/26

ENG. STAMP

Chugach Electric Association, Inc.
5601 Electron Drive - P.O. Box 196300
Anchorage, Alaska 99519-6300

DRAWING NAME: **RBSS 312 PD TESTING & REPAIR SYSTEM IMPROVEMENT**
1820, 1821, 1822, 1920, 2019, 2024 / 1304-32, 1304-33, 1204-03, 1204-06
RBSS 312

W.O. NO.: **E2214138**

E2214138 DRAWNGS.dwg
PAGE 4 OF 12

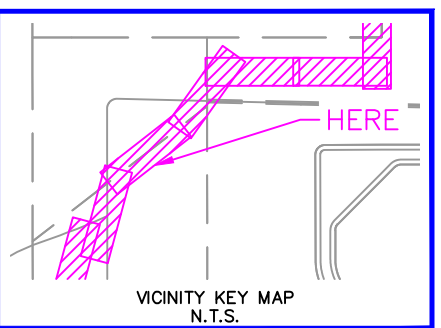
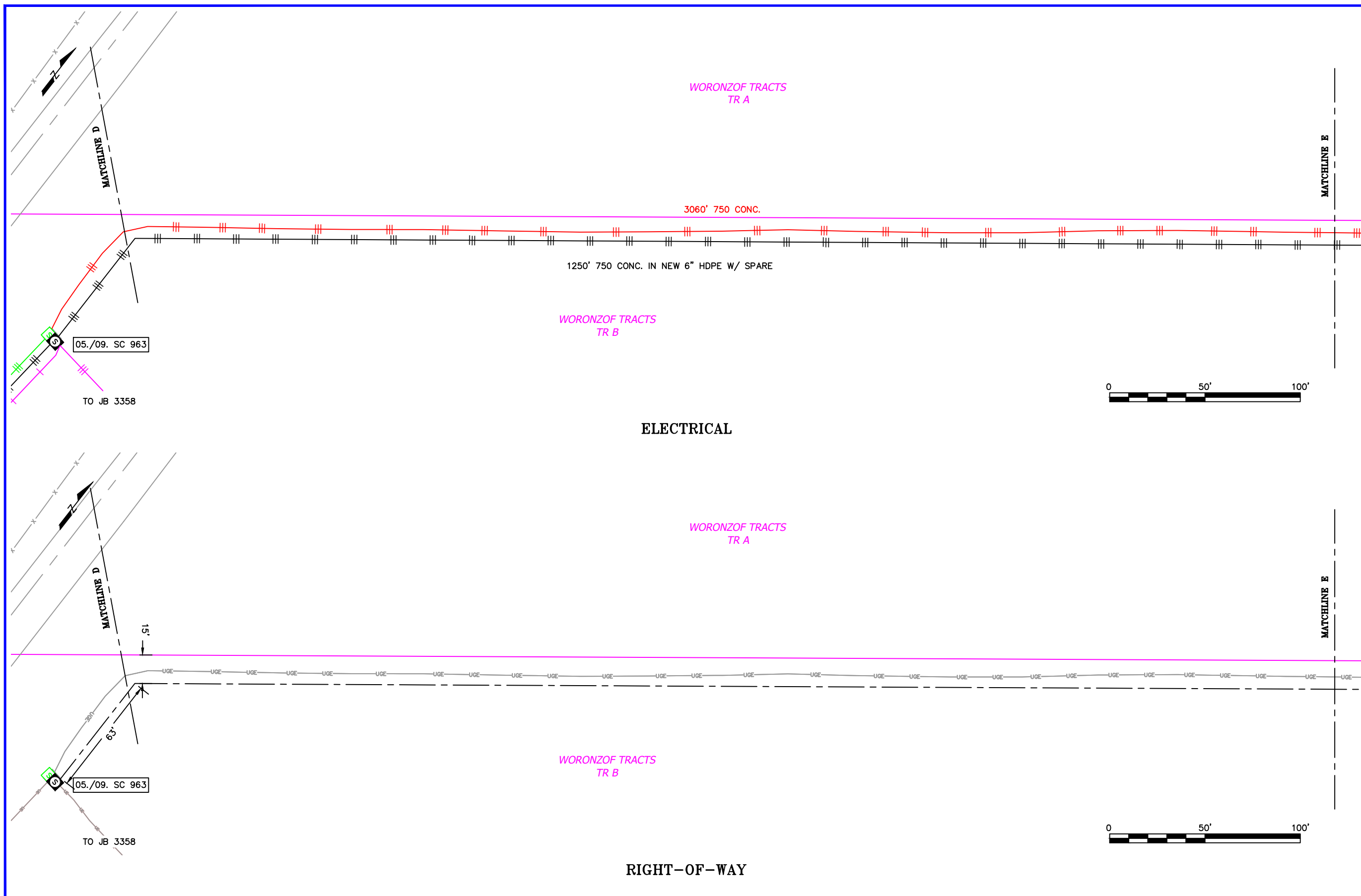

NEW	EXISTING	DESC.
[V]	[V]	VAULT
[J]	[J]	JUNCTION BOX
[S]	[S]	SWITCH CABINET
[P]	[P]	PULLBOX
[F]	[F]	PADMOUNT XFMR
[M]	[M]	FUSED JUNCTION BOX
[M]	[M]	PRIMARY METER
[▲]	[▲]	HANDHOLE
[▲]	[▲]	PEDESTAL
⊗	⊗	NON-CEA POLE
●	○	POLE
●*	○*	LIGHT
↘	↘	DOWN GUY
~	~	FUSE
◆	◇	SPLICE POINT
⌵	⌵	1Ø OH XFMR
⌵⌵	⌵⌵	DELTA OH XFMR
⌵⌵⌵	⌵⌵⌵	3Ø OH XFMR
-FO-	-FO-	FIBER OPTIC
///	///	O.H. XMSSN
-//-	-//-	U.G. XMSSN
X	X	SPAN GUY
—2"	—2"	CONDUIT DIAMETER
		1Ø U.G. PRIMARY
		2Ø U.G. PRIMARY
		3Ø U.G. PRIMARY
- - -	- - -	U.G. SECONDARY
- - -	- - -	U.G. SERVICE
- - -	- - -	1Ø O.H. PRIMARY
- - -	- - -	2Ø O.H. PRIMARY
- - -	- - -	3Ø O.H. PRIMARY
- - -	- - -	R.O.W. EASEMENT LINE
- - -	- - -	CENTERLINE OF TRENCH

COLOR LEGEND	
— (Black)	NEW
— (Grey)	REFERENCE
— (Pink)	EXISTING
— (Green)	RETIRE
— (Red)	ABANDON

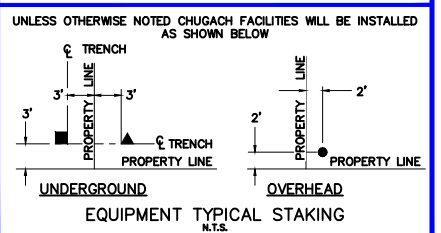

PROJECT: RBSS 312 PD TESTING & REPAIR - SI			
DESIGNER/PROJECT ENGINEER: E. COOK		W.O. #: E2214138	
NO.	DESIGN/CONSTRUCTION/AS-BUILT REVISION	DWN BY/DATE	APPROVED/DATE
0	ISSUE FOR CONSTRUCTION	EC 2/24/26	Jm 3/20/26

ENG. STAMP

Chugach Electric Association, Inc.
5601 Electron Drive - P.O. Box 196300
Anchorage, Alaska 99519-6300

DRAWING NAME: **RBSS 312 PD TESTING & REPAIR SYSTEM IMPROVEMENT**
1820, 1821, 1822, 1920, 2019, 2024 / 1304-32, 1304-33, 1204-03, 1204-06
RBSS 312

W.O. NO.: **E2214138**

E2214138 DRAWNGS.dwg
PAGE 5 OF 12

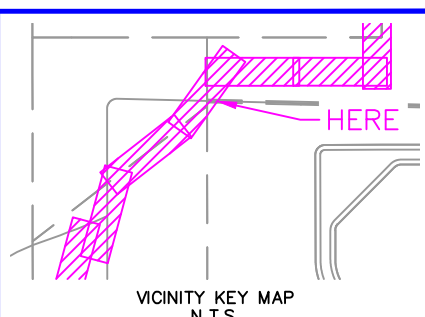
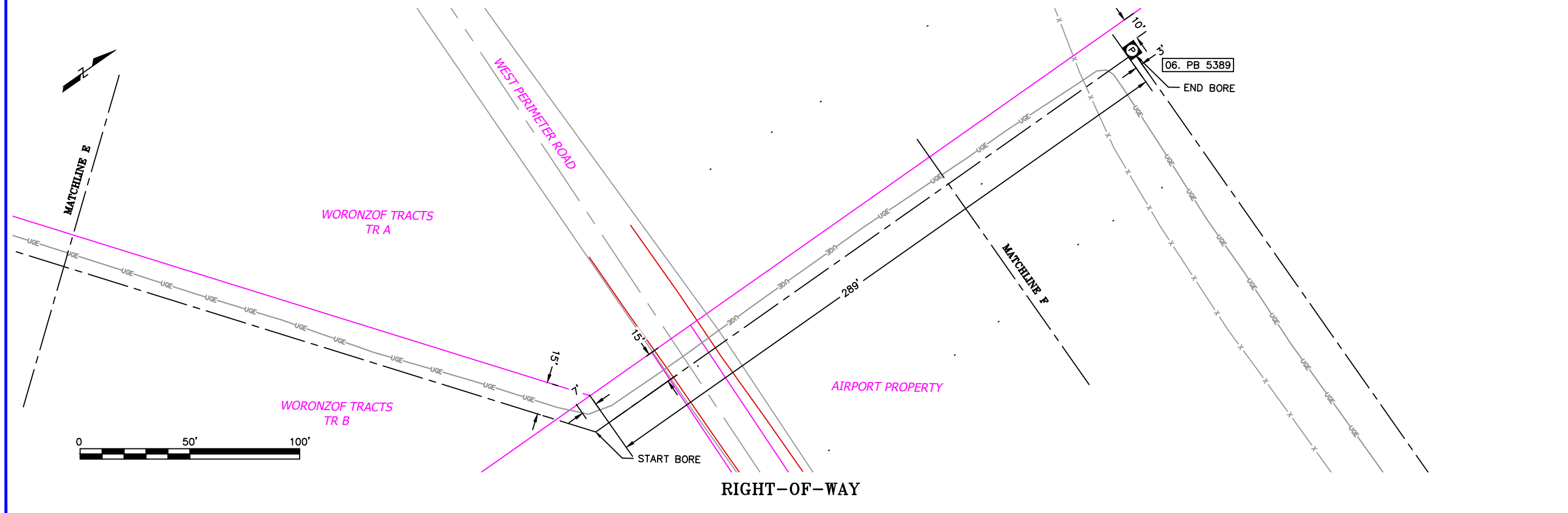
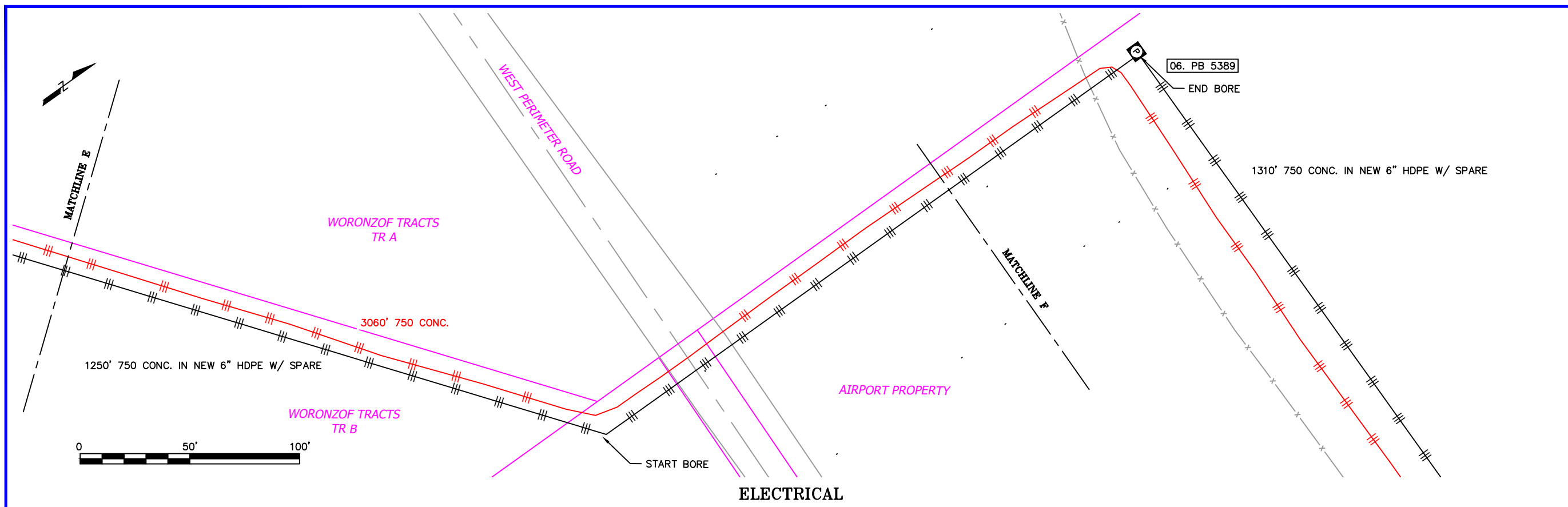

NEW	EXISTING	DESC.
		VAULT
		JUNCTION BOX
		SWITCH CABINET
		PULLBOX
		PADMOUNT XFMR
		FUSED JUNCTION BOX
		PRIMARY METER
		HANDHOLE
		PEDESTAL
		NON-CEA POLE
		POLE
		LIGHT
		DOWN GUY
		FUSE
		SPLICE POINT
		1Ø OH XFMR
		DELTA OH XFMR
		3Ø OH XFMR
		FIBER OPTIC
		O.H. XMSSN
		U.G. XMSSN
		SPAN GUY
		CONDUIT DIAMETER
		1Ø U.G. PRIMARY
		2Ø U.G. PRIMARY
		3Ø U.G. PRIMARY
		U.G. SECONDARY
		U.G. SERVICE
		1Ø O.H. PRIMARY
		2Ø O.H. PRIMARY
		3Ø O.H. PRIMARY
		R.O.W. EASEMENT LINE
		CENTERLINE OF TRENCH

COLOR	DESC.
	NEW
	REFERENCE
	EXISTING
	RETIRE
	ABANDON

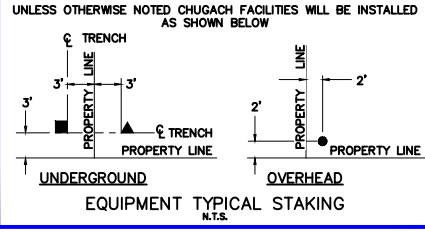

PROJECT: RBSS 312 PD TESTING & REPAIR - SI			
DESIGNER/PROJECT ENGINEER: E. COOK		W.O. #: E2214138	
NO.	DESIGN/CONSTRUCTION/AS-BUILT REVISION	DWN BY/DATE	APPROVED/DATE
0	ISSUE FOR CONSTRUCTION	EC 2/24/26	<i>Jm</i> 3/20/26

ENG. STAMP

Chugach Electric Association, Inc.
5601 Electron Drive - P.O. Box 196300
Anchorage, Alaska 99519-6300

DRAWING NAME: **RBSS 312 PD TESTING & REPAIR SYSTEM IMPROVEMENT**
1820, 1821, 1822, 1920, 2019, 2024 / 1304-32, 1304-33, 1204-03, 1204-06
RBSS 312

W.O. NO.: **E2214138**

E2214138 DRAWNGS.dwg
PAGE 6 OF 12

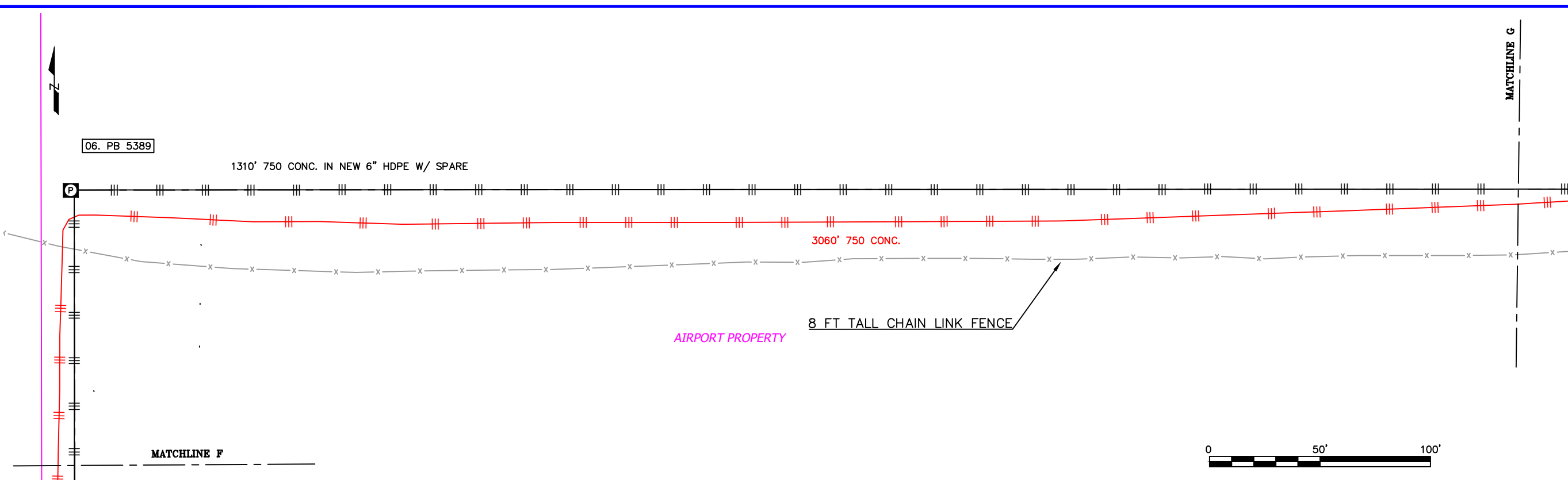

ELECTRICAL

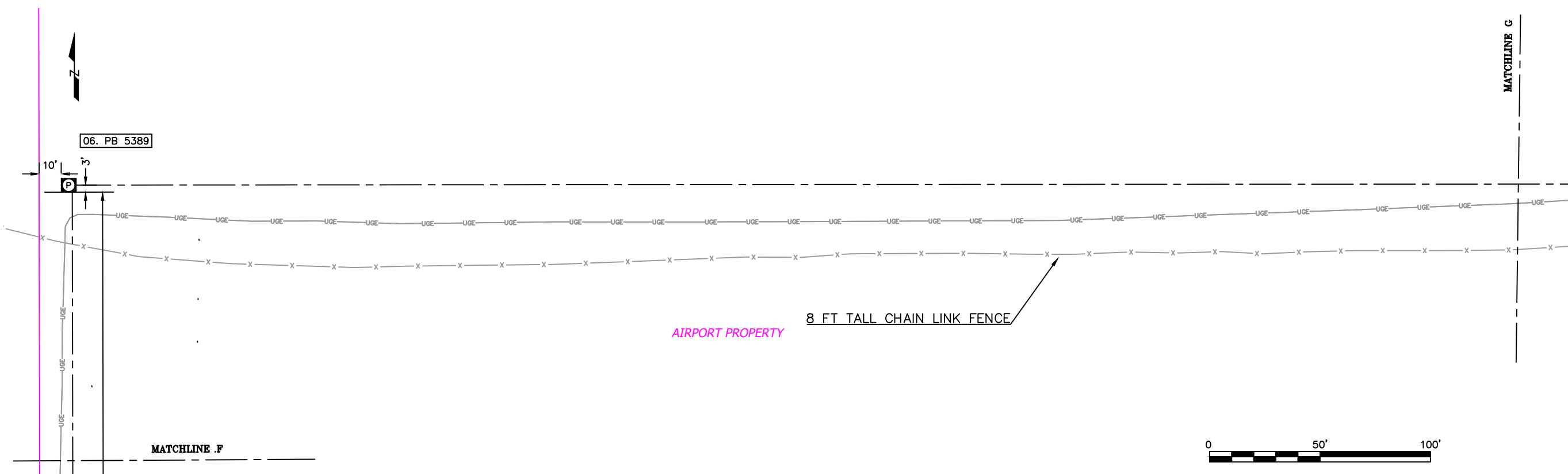
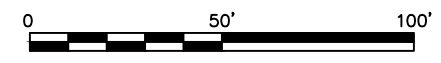

RIGHT-OF-WAY

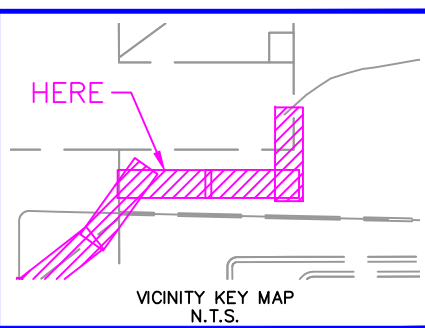
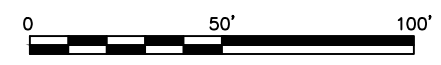

NEW	EXISTING	DESC.
[V]	[V]	VAULT
[J]	[J]	JUNCTION BOX
[S]	[S]	SWITCH CABINET
[P]	[P]	PULLBOX
[F]	[F]	PADMOUNT XFMR
[M]	[M]	FUSED JUNCTION BOX
[M]	[M]	PRIMARY METER
[▲]	[▲]	HANDHOLE
[⊗]	[⊗]	NON-CEA POLE
[●]	[●]	POLE
[*]	[*]	LIGHT
[↓]	[↓]	DOWN GUY
[~]	[~]	FUSE
[◇]	[◇]	SPLICE POINT
[⌵]	[⌵]	1Ø OH XFMR
[⌵⌵]	[⌵⌵]	DELTA OH XFMR
[⌵⌵⌵]	[⌵⌵⌵]	3Ø OH XFMR
[FO]	[FO]	FIBER OPTIC
[//]	[//]	O.H. XMSSN
[-//]	[-//]	U.G. XMSSN
[X]	[X]	SPAN GUY
[2"]	[2"]	CONDUIT DIAMETER
[+]	[+]	1Ø U.G. PRIMARY
[=]	[=]	2Ø U.G. PRIMARY
[≡]	[≡]	3Ø U.G. PRIMARY
[---]	[---]	U.G. SECONDARY
[---]	[---]	U.G. SERVICE
[---]	[---]	1Ø O.H. PRIMARY
[---]	[---]	2Ø O.H. PRIMARY
[---]	[---]	3Ø O.H. PRIMARY
[---]	[---]	R.O.W. EASEMENT LINE
[---]	[---]	CENTERLINE OF TRENCH

COLOR LEGEND	
[Black line]	NEW
[Grey line]	REFERENCE
[Pink line]	EXISTING
[Green line]	RETIRE
[Red line]	ABANDON

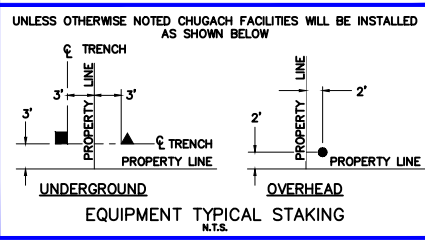

PROJECT: RBSS 312 PD TESTING & REPAIR - SI		W.O. #: E2214138	
DESIGNER/PROJECT ENGINEER: E. COOK			
NO.	DESIGN/CONSTRUCTION/AS-BUILT REVISION	DWN BY/DATE	APPROVED/DATE
0	ISSUE FOR CONSTRUCTION	EC 2/24/26	[Signature] 3/20/26

ENG. STAMP

Chugach Electric Association, Inc.
5601 Electron Drive - P.O. Box 196300
Anchorage, Alaska 99519-6300

DRAWING NAME: **RBSS 312 PD TESTING & REPAIR SYSTEM IMPROVEMENT**
1820, 1821, 1822, 1920, 2019, 2024 / 1304-32, 1304-33, 1204-03, 1204-06
RBSS 312

W.O. NO.: **E2214138**

E2214138 DRAWNGS.dwg
PAGE 7 OF 12

3060' 750 CONC. CONTINUED TO SC 606

1310' 750 CONC. IN NEW 6" HDPE W/ SPARE

AIRPORT PROPERTY

ELECTRICAL

AIRPORT PROPERTY

RIGHT-OF-WAY

MATCHLINE H

MATCHLINE H

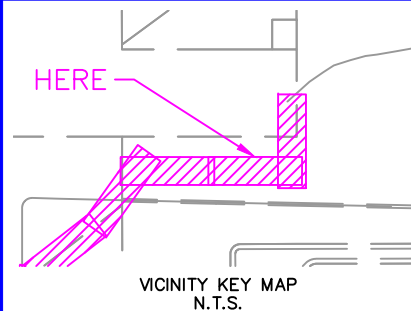
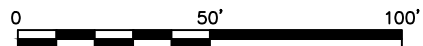
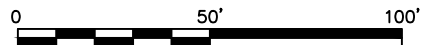

NEW	EXISTING	DESC.
		VAULT
		JUNCTION BOX
		SWITCH CABINET
		PULLBOX
		PADMOUNT XFMR
		FUSED JUNCTION BOX
		PRIMARY METER
		HANDHOLE
		PEDESTAL
		NON-CEA POLE
		POLE
		LIGHT
		DOWN GUY
		FUSE
		SPLICE POINT
		1Ø OH XFMR
		DELTA OH XFMR
		3Ø OH XFMR
		FIBER OPTIC
		O.H. XMSSN
		U.G. XMSSN
		SPAN GUY
		CONDUIT DIAMETER
		1Ø U.G. PRIMARY
		2Ø U.G. PRIMARY
		3Ø U.G. PRIMARY
		U.G. SECONDARY
		U.G. SERVICE
		1Ø O.H. PRIMARY
		2Ø O.H. PRIMARY
		3Ø O.H. PRIMARY
		R.O.W. EASEMENT LINE
		CENTERLINE OF TRENCH

COLOR LEGEND	
	NEW
	REFERENCE
	EXISTING
	RETIRE
	ABANDON

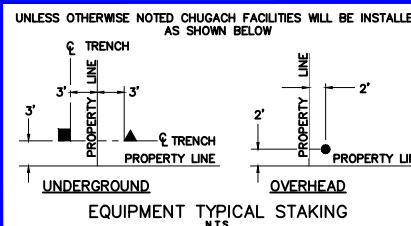

PROJECT: RBSS 312 PD TESTING & REPAIR - SI			
DESIGNER/PROJECT ENGINEER: E. COOK		W.O. #: E2214138	
NO.	DESIGN/CONSTRUCTION/AS-BUILT REVISION	DWN BY/DATE	APPROVED/DATE
0	ISSUE FOR CONSTRUCTION	EC 2/24/26	3/20/26

ENG. STAMP



Chugach Electric Association, Inc.
5601 Electron Drive - P.O. Box 196300
Anchorage, Alaska 99519-6300

DRAWING NAME:	RBSS 312 PD TESTING & REPAIR SYSTEM IMPROVEMENT
	1820, 1821, 1822, 1920, 2019, 2024 / 1304-32, 1304-33, 1204-03, 1204-06 RBSS 312
W.O. NO.:	E2214138
	E2214138 DRAWINGS.dwg
	PAGE 8 OF 12

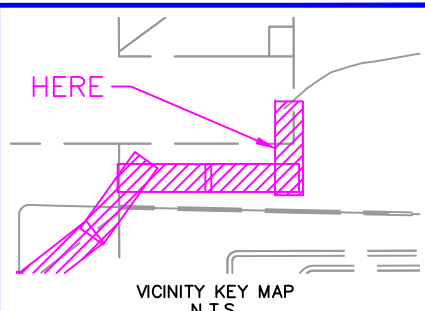
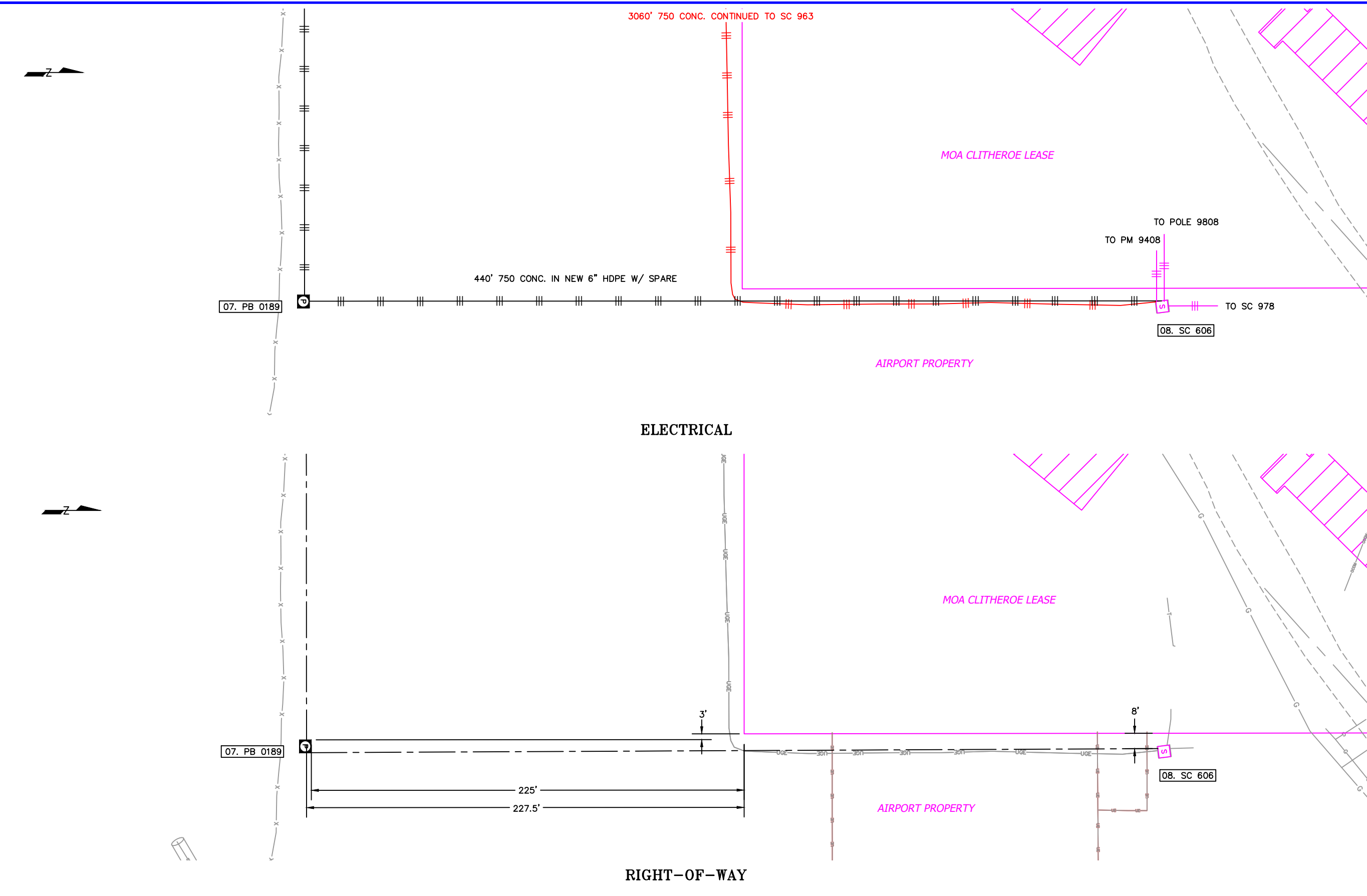

NEW	EXISTING	DESC.
		VAULT
		JUNCTION BOX
		SWITCH CABINET
		PULLBOX
		PADMOUNT XFMR
		FUSED JUNCTION BOX
		PRIMARY METER
		HANDHOLE
		PEDESTAL
		NON-CEA POLE
		POLE
		LIGHT
		DOWN GUY
		FUSE
		SPLICE POINT
		1Ø OH XFMR
		DELTA OH XFMR
		3Ø OH XFMR
		FIBER OPTIC
		O.H. XMSSN
		U.G. XMSSN
		SPAN GUY
		CONDUIT DIAMETER
		1Ø U.G. PRIMARY
		2Ø U.G. PRIMARY
		3Ø U.G. PRIMARY
		U.G. SECONDARY
		U.G. SERVICE
		1Ø O.H. PRIMARY
		2Ø O.H. PRIMARY
		3Ø O.H. PRIMARY
		R.O.W. EASEMENT LINE
		CENTERLINE OF TRENCH

COLOR LEGEND	
	NEW
	REFERENCE
	EXISTING
	RETIRE
	ABANDON

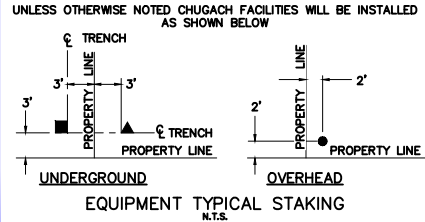

PROJECT: RBSS 312 PD TESTING & REPAIR - SI		W.O. #: E2214138	
DESIGNER/PROJECT ENGINEER: E. COOK			
NO.	DESIGN/CONSTRUCTION/AS-BUILT REVISION	DWN BY/DATE	APPROVED/DATE
0	ISSUE FOR CONSTRUCTION	EC 2/24/26	<i>Jm</i> 3/20/26

ENG. STAMP

Chugach Electric Association, Inc.
5601 Electron Drive - P.O. Box 196300
Anchorage, Alaska 99519-6300

DRAWING NAME: **RBSS 312 PD TESTING & REPAIR SYSTEM IMPROVEMENT**
1820, 1821, 1822, 1920, 2019, 2024 / 1304-32, 1304-33, 1204-03, 1204-06
RBSS 312

W.O. NO.: **E2214138**

E2214138 DRAWINGS.dwg
PAGE 9 OF 12

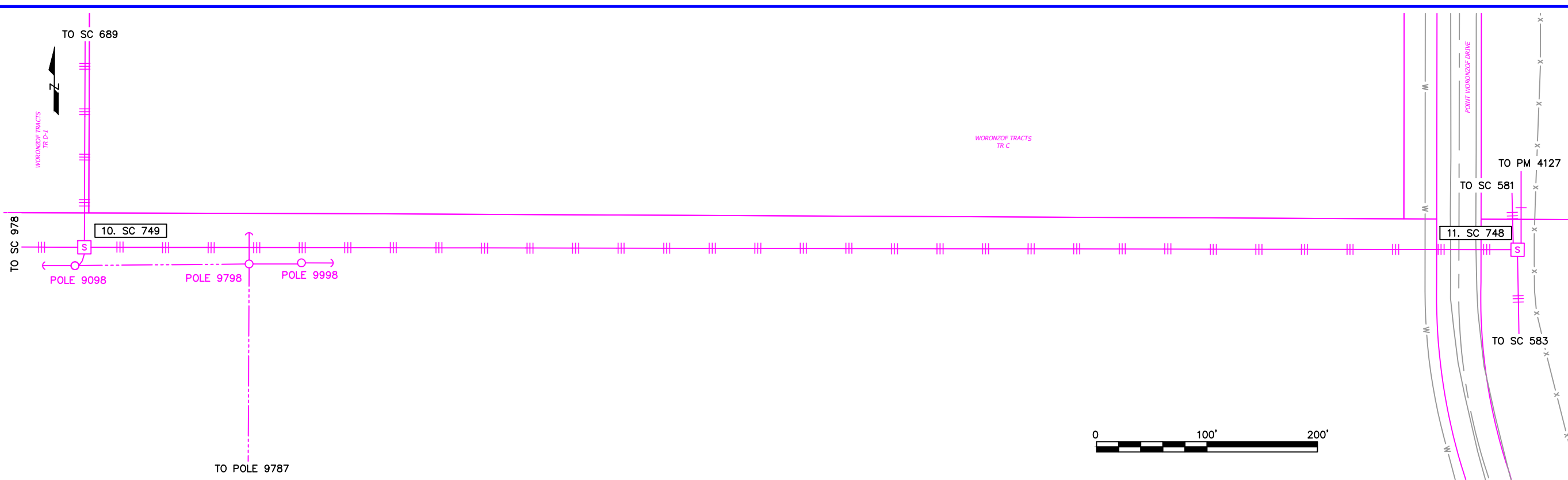

ELECTRICAL

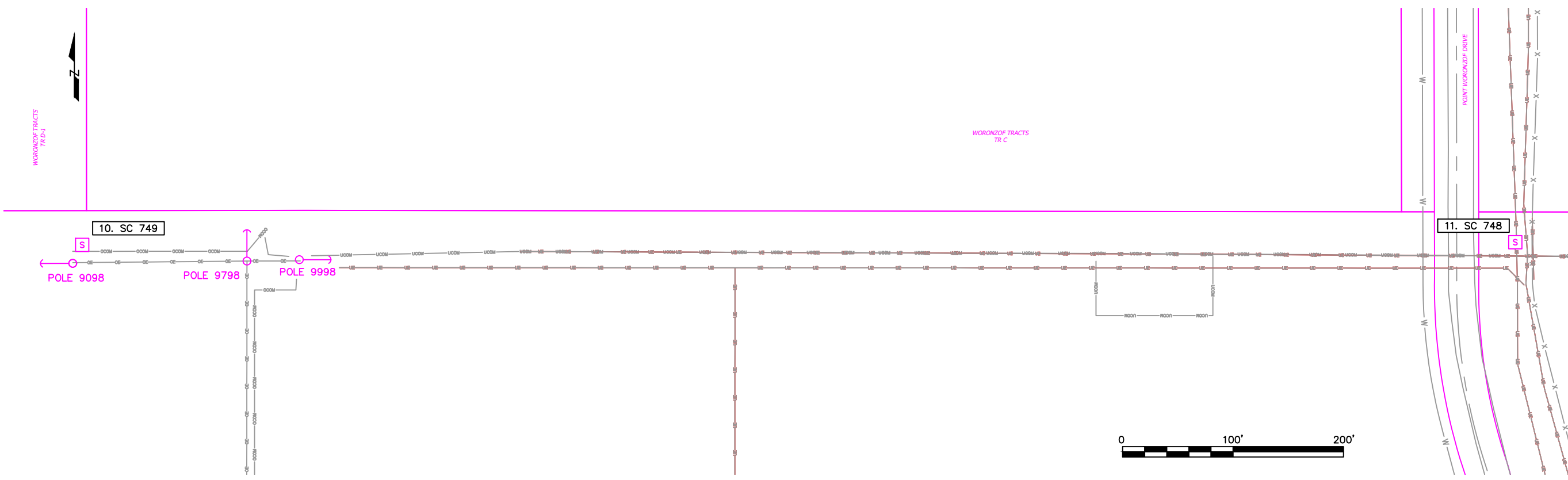

RIGHT-OF-WAY

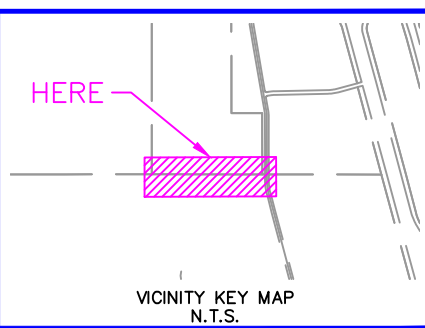

LEGEND		DESC.
NEW	EXISTING	
		VAULT
		JUNCTION BOX
		SWITCH CABINET
		PULLBOX
		PADMOUNT XFMR
		FUSED JUNCTION BOX
		PRIMARY METER
		HANDHOLE
		PEDESTAL
		NON-CEA POLE
		POLE
		LIGHT
		DOWN GUY
		FUSE
		SPLICE POINT
		1Ø OH XFMR
		DELTA OH XFMR
		3Ø OH XFMR
		FIBER OPTIC
		O.H. XMSSN
		U.G. XMSSN
		SPAN GUY
		CONDUIT DIAMETER
		1Ø U.G. PRIMARY
		2Ø U.G. PRIMARY
		3Ø U.G. PRIMARY
		U.G. SECONDARY
		U.G. SERVICE
		1Ø O.H. PRIMARY
		2Ø O.H. PRIMARY
		3Ø O.H. PRIMARY
		R.O.W. EASEMENT LINE
		CENTERLINE OF TRENCH

COLOR LEGEND	
	NEW
	REFERENCE
	EXISTING
	RETIRE
	ABANDON

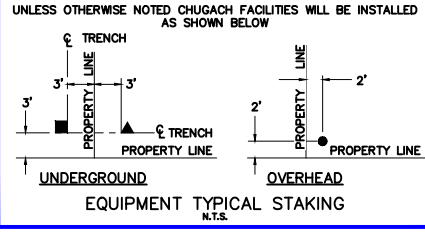

PROJECT: RBSS 312 PD TESTING & REPAIR - SI			
DESIGNER/PROJECT ENGINEER: E. COOK		W.O. #: E2214138	
NO.	DESIGN/CONSTRUCTION/AS-BUILT REVISION	DWN BY/DATE	APPROVED/DATE
0	ISSUE FOR CONSTRUCTION	EC 2/24/26	<i>Jm</i> 3/20/26

ENG. STAMP

Chugach Electric Association, Inc.
5601 Electron Drive - P.O. Box 196300
Anchorage, Alaska 99519-6300

DRAWING NAME: **RBSS 312 PD TESTING & REPAIR SYSTEM IMPROVEMENT**
1820, 1821, 1822, 1920, 2019, 2024 / 1304-32, 1304-33, 1204-03, 1204-06
RBSS 312

W.O. NO.: **E2214138**

E2214138 DRAWNGS.dwg
PAGE 10 OF 12

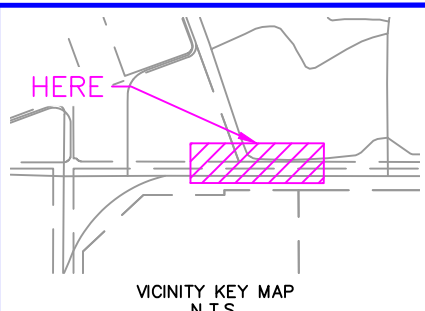
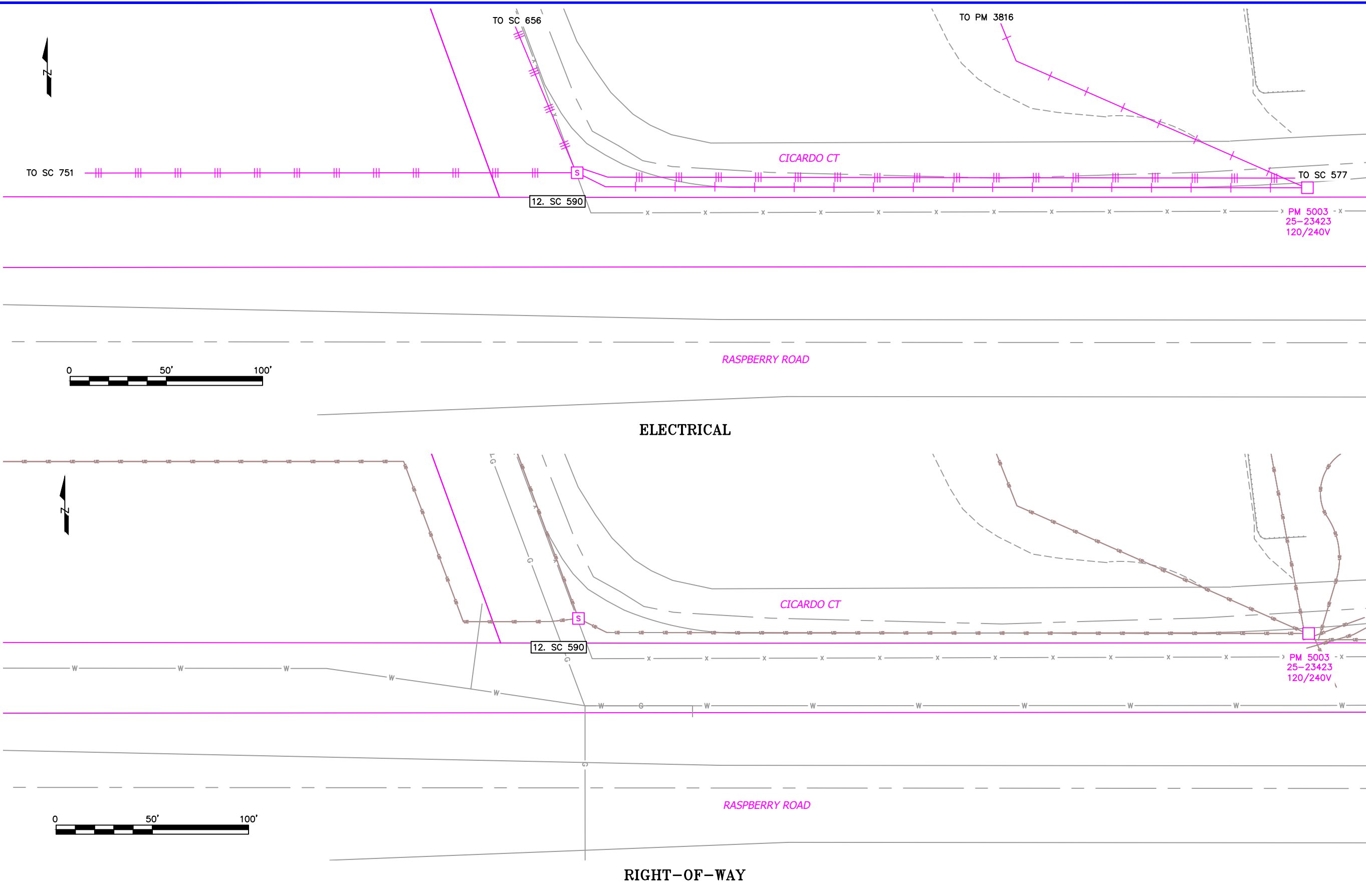

NEW	EXISTING	DESC.
[V]	[V]	VAULT
[J]	[J]	JUNCTION BOX
[S]	[S]	SWITCH CABINET
[P]	[P]	PULLBOX
[F]	[F]	PADMOUNT XFMR
[M]	[M]	FUSED JUNCTION BOX
[▲]	[▲]	PRIMARY METER
[▲]	[▲]	HANDHOLE
[⊗]	[⊗]	PEDESTAL
[●]	[●]	NON-CEA POLE
[●]	[○]	POLE
[*]	[*]	LIGHT
[↓]	[↓]	DOWN GUY
[~]	[~]	FUSE
[◇]	[◇]	SPLICE POINT
[⌵]	[⌵]	1Ø OH XFMR
[⌵⌵]	[⌵⌵]	DELTA OH XFMR
[⌵⌵⌵]	[⌵⌵⌵]	3Ø OH XFMR
[FO]	[FO]	FIBER OPTIC
[//]	[//]	O.H. XMSSN
[-//]	[-//]	U.G. XMSSN
[X]	[X]	SPAN GUY
[2"]	[2"]	CONDUIT DIAMETER
[]	[]	1Ø U.G. PRIMARY
[]	[]	2Ø U.G. PRIMARY
[]	[]	3Ø U.G. PRIMARY
[---]	[---]	U.G. SECONDARY
[---]	[---]	U.G. SERVICE
[---]	[---]	1Ø O.H. PRIMARY
[---]	[---]	2Ø O.H. PRIMARY
[---]	[---]	3Ø O.H. PRIMARY
[---]	[---]	R.O.W. EASEMENT LINE
[---]	[---]	CENTERLINE OF TRENCH

COLOR LEGEND	
[Solid Black Line]	NEW
[Dashed Black Line]	REFERENCE
[Pink Line]	EXISTING
[Green Line]	RETIRE
[Red Line]	ABANDON

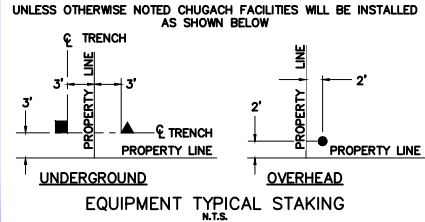

PROJECT: RBSS 312 PD TESTING & REPAIR - SI		W.O. #: E2214138	
DESIGNER/PROJECT ENGINEER: E. COOK			
NO.	DESIGN/CONSTRUCTION/AS-BUILT REVISION	DWN BY/DATE	APPROVED/DATE
0	ISSUE FOR CONSTRUCTION	EC 2/24/26	[Signature] 3/20/26

ENG. STAMP

Chugach Electric Association, Inc.
5601 Electron Drive - P.O. Box 196300
Anchorage, Alaska 99519-6300

DRAWING NAME: **RBSS 312 PD TESTING & REPAIR SYSTEM IMPROVEMENT**
1820, 1821, 1822, 1920, 2019, 2024 / 1304-32, 1304-33, 1204-03, 1204-06
RBSS 312

W.O. NO.: **E2214138**

E2214138 DRAWNGS.dwg
PAGE 11 OF 12

